

Facilities Planning and Construction  
Suzanne A. Marshall, Chief Facilities Officer (Construction)

**SUBJECT: AUTHORIZATION TO ENTER INTO A TEMPORARY SLOPE AND FILL AGREEMENT WITH SPRINGHILL SMC CORPORATION (MARRIOTT INTERNATIONAL, INC.) FOR THE DEMUCKING AND FILLING OF A PORTION OF THE STATE SCHOOL "C" SITE**

Marriott International, Inc. (Marriott) is requesting Board approval of the above referenced agreement. Marriott will be developing a SpringHill Suites by Marriott hotel on a 2.58 acre site adjacent to the State School "C" site. Due to the small site size and requisite fill requirements, Marriott wishes to slope the fill on to a portion of the Board-owned property (see attached location map). The fill area as proposed will be 20' wide. In the future, when the District is prepared to construct State School "C", the District will then demuck the remainder of the school parcel and fill it to the appropriate matching elevation.

If the agreement is approved, the District would benefit in two ways. Marriott has agreed to pay the wetland mitigation costs (approximately \$12,300.00) associated with the filling of .334 acres of land plus administrative costs. Also, a cost savings would be realized by the District due to the partial demucking and filling of the referenced 20' strip.

The proposed agreement has been reviewed by the School Board Attorney's Office and the Office of Risk and Benefits Management. The Department of Facilities Planning & Construction recommends approval of this item. The Department of Safety, Environment and Hazards Management is in agreement with the proposed agreement.

A copy of the proposed agreement will be placed on file in both the Citizen's Information Center and Recording Secretary's Office.

**RECOMMENDED:** That The School Board of Miami-Dade County, Florida, authorize the Chair and Secretary to execute the Temporary Slope and Fill Agreement with SpringHill SMC Corporation for the demucking and filling of a portion of the State School "C" site.

AAD:lh

# LOCATION MAP

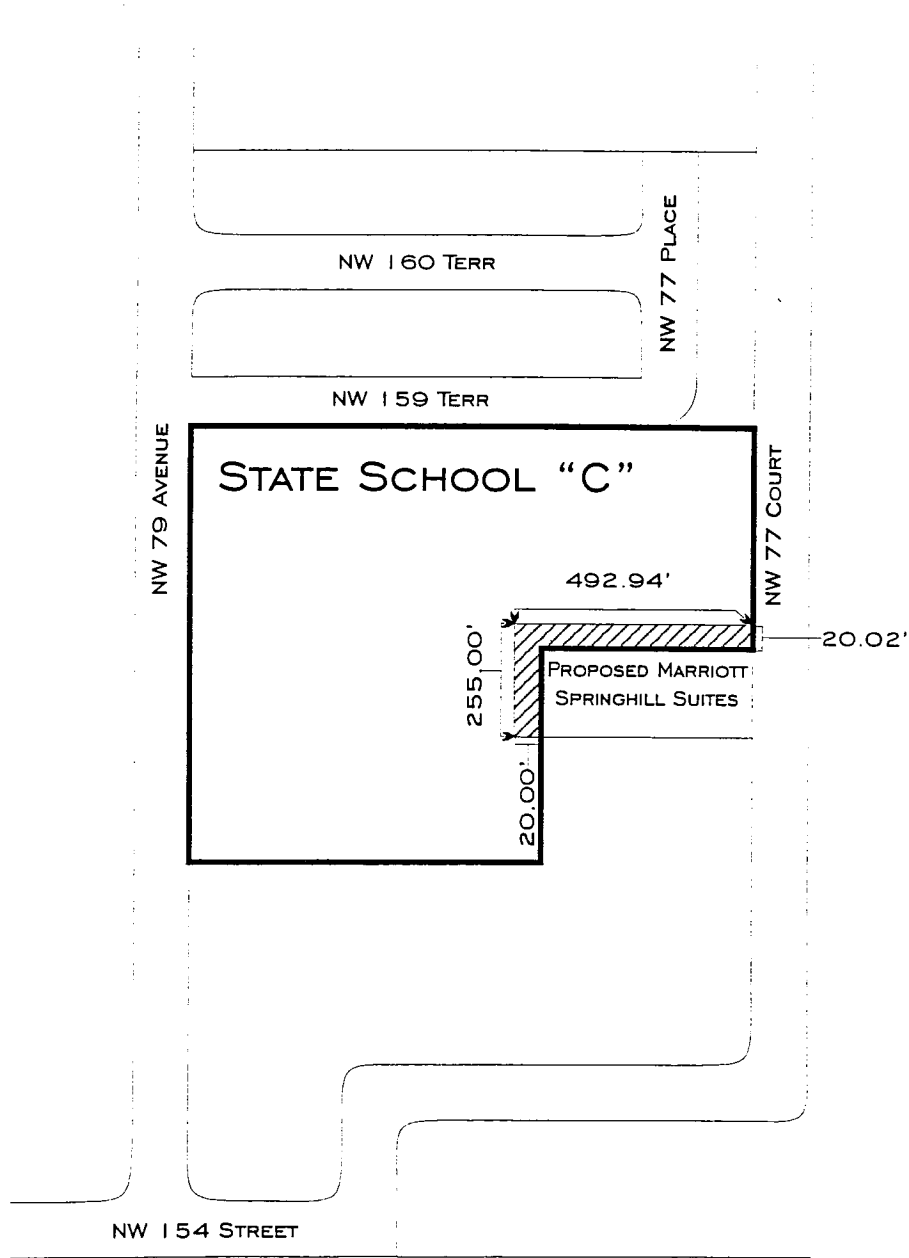

**LEGEND**

 20' SLOPE AND FILL AREA  
(.334 ACRES OF  
BOARD OWNED PROPERTY)

