

Business Operations
Ofelia San Pedro, Deputy Superintendent

SUBJECT: RENEWAL OF LEASE AGREEMENT WITH INNER CITY YOUTH OF SOUTH FLORIDA - YOUTH ATHLETIC LEAGUE, INC., FOR THE USE OF THE PLAYFIELD AREA AT LILLIE C. EVANS ELEMENTARY SCHOOL, LOCATED AT 1895 NW 75 STREET, MIAMI

COMMITTEE: FACILITIES AND CONSTRUCTION REFORM

Since December 2003, the School Board (Board) has leased the playfield area at Lillie C. Evans Elementary School, located at 1895 NW 75 Street, to Inner City Youth of South Florida – Youth Athletic League, Inc. (ICY), a non-profit organization, for its youth sports program during non-school hours (see location map). This youth sports program serves approximately 260 children from the surrounding community during the hours of 4:30 p.m. to 8:00 p.m., Monday through Friday, and 8:00 a.m. to 8:00 p.m. on Saturday and Sunday. ICY has completed its initial one-year term. This proposed renewal represents the first of three one-year renewal option periods available under the lease agreement. The term of the renewal option period will commence December 1, 2004, and will end November 30, 2005.

All terms and conditions of the lease agreement will remain unchanged, including the following:

- annual lease rate of \$1.00;
- ICY is responsible for maintaining the premises in a safe, clean and secure manner during its use and for the removal of litter and trash;
- the District is responsible for routine maintenance of the recreational facility and grounds; and
- either party may cancel at any time by giving the other 60 days prior written notice.

Staff contacted the Principal of Lillie C. Evans Elementary School, the Assistant Superintendent of Region 3, and the Associate Superintendent of Region Operations, who recommend the renewal of the lease term for an additional one-year period.

RECOMMENDED:

That The School Board of Miami-Dade County, Florida, authorize the renewal of the lease agreement with Inner City Youth of South Florida – Youth Athletic League, Inc., for use of the playfield area at Lillie C. Evans Elementary School, at an annual rental rate of \$1.00. The term of the renewal option period will commence December 1, 2004, and will end November 30, 2005. All other terms and conditions of the lease agreement will remain unchanged.

CDR:rr

LOCATION MAP

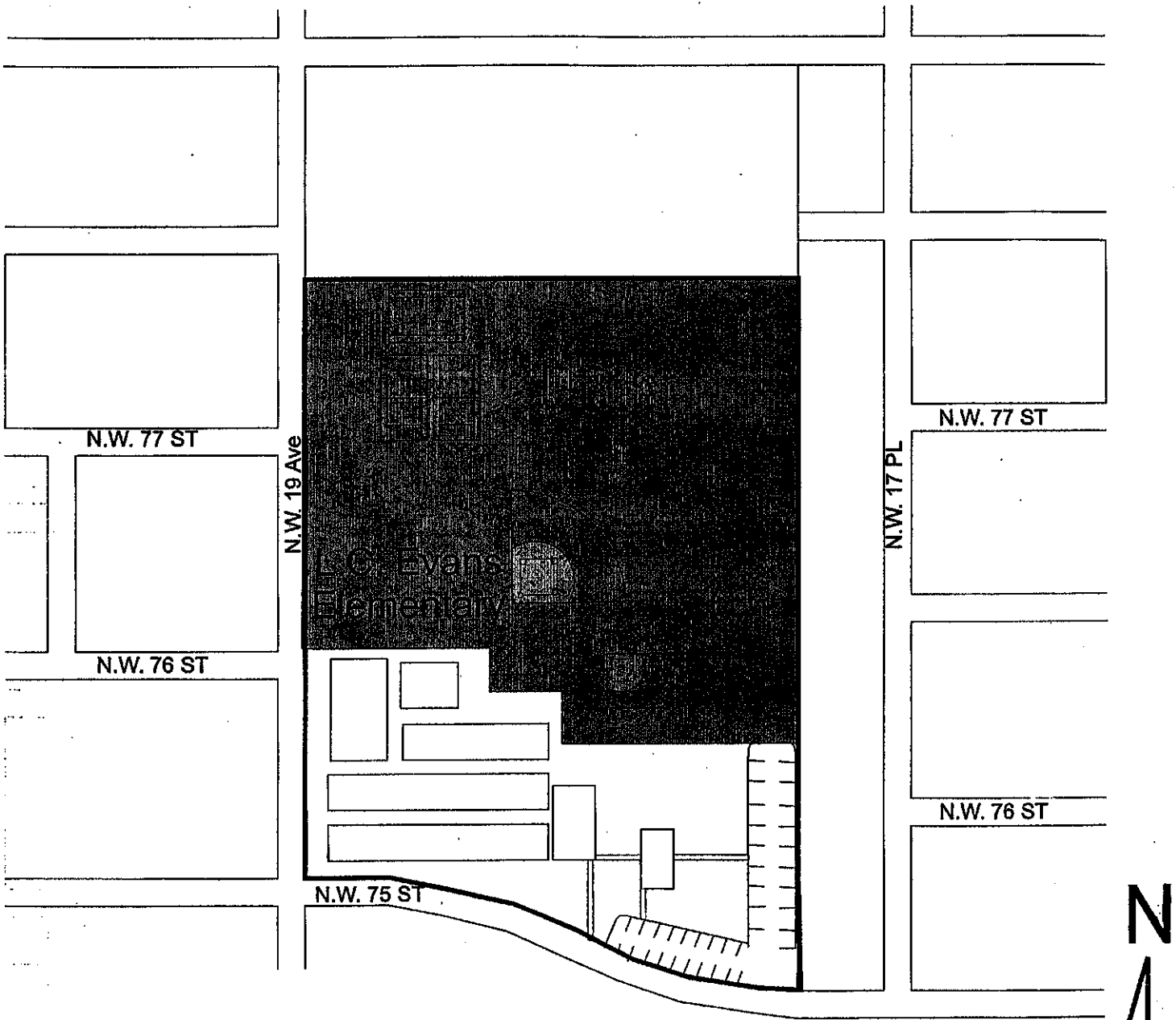

Legend

 Demised Premises