

Business Operations
Ofelia San Pedro, Deputy Superintendent

SUBJECT: AUTHORIZATION FOR THE SUPERINTENDENT TO FINALIZE NEGOTIATIONS AND FOR THE BOARD TO DEDICATE BOARD-OWNED LAND TO THE CITY OF HIALEAH GARDENS FOR RIGHT-OF-WAY PURPOSES ADJACENT TO PROPOSED STATE SCHOOLS "JJJ" (RELIEF SCHOOL FOR BARBARA GOLEMAN SENIOR HIGH), "MM1" (RELIEF SCHOOL FOR JOSE MARTI AND HENRY FILER MIDDLE) and "V1" (RELIEF SCHOOL FOR ERNEST R GRAHAM AND SHEPARD ELEMENTARY), LOCATED AT NW 92 AVENUE AND HIALEAH GARDENS BOULEVARD, HIALEAH GARDENS, FLORIDA

COMMITTEE: FACILITIES AND CONSTRUCTION REFORM

The School Board owns approximately 56 acres of land located at NW 92 Avenue and Hialeah Gardens Boulevard, which was purchased to situate State Schools "JJJ", "MM1" and "V1". As part of the ongoing discussions with the City of Hialeah Gardens (City), the dedication of a proposed right-of-way at the northern end of the property is desirable to facilitate access to and from the campus. Based on discussions with City staff, the right-of-way would be approximately 60 feet in width by the length of the property (approximately 750 feet) for a total dedication of approximately one acre (see location map). Therefore, it is recommended that the Board authorize the Superintendent to finalize negotiations with the City, and subsequently proceed with the subject right-of-way dedication.

The right-of-way document will be reviewed by the School Board Attorney's Office and the Office of Risk and Benefits Management prior to execution. The Superintendent for Region Center I recommends approval of this dedication. The Department of Safety, Environment and Hazard Management is in agreement with the proposed dedication of right-of-way.

F - 3

RECOMMENDED:

That The School Board of Miami-Dade County, Florida, authorize the Superintendent to finalize negotiations and for the Board Chair and Secretary to execute the necessary documents to dedicate land to the City of Hialeah Gardens for right-of-way purposes adjacent to State Schools "JJJ", "V1" and "MM-1", located at NW 92 Avenue and Hialeah Gardens Boulevard, Hialeah Gardens, Florida, as described above.

JB:rr

LOCATION MAP

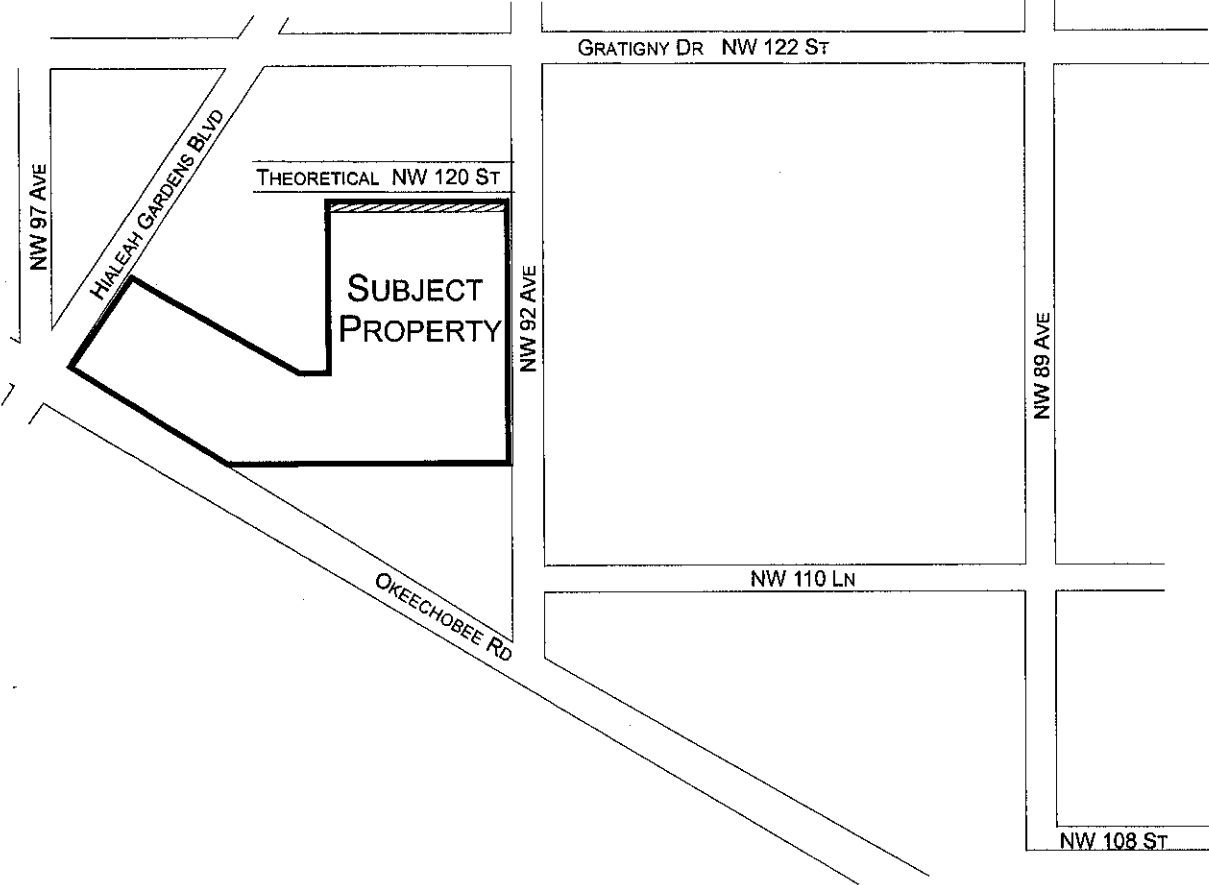

LEGEND

— +/- 56.2 ACRES-SUBJECT PROPERTY
(STATE SCHOOL "JJJ", STATE SCHOOL "MM1"
AND STATE SCHOOL "V1")

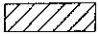
 PROPOSED DEDICATION (60' X 750' =
45,000 SQ. FT. OR 1.03 ACRES)

(NOT TO SCALE)

