

Business Operations
Rose Diamond, Chief Facilities Officer

SUBJECT: AUTHORIZATION TO DEDICATE A PORTION OF VACANT BOARD-OWNED LAND LOCATED AT SW 157 AVENUE BETWEEN SW 45 STREET AND SW 44 TERRACE, MIAMI, TO MIAMI-DADE COUNTY FOR RIGHT-OF-WAY PURPOSES

COMMITTEE: FACILITIES AND CONSTRUCTION REFORM

In 1999, the Board acquired approximately 25 acres of vacant land at SW 157 Avenue and SW 45 Street for the construction of future educational facilities. Subsequently, the Board completed road improvements along SW 157 Avenue, including a portion of the vacant Board-owned property, as part of the construction of the nearby Lamar Louise Curry Middle School. Miami-Dade County (County), has requested that the District now dedicate the portion of the vacant Board-owned site currently being used as roadway, for right-of-way purposes (see location map).

The land to be dedicated to the County totals 13,230 square feet (.34 acres, more or less), and is more fully described in Exhibit "A", attached hereto.

The right of way document will be reviewed by the School Board Attorney's Office and the Office of Risk and Benefits Management prior to execution. Maintenance Operations and the Regional Superintendent for Regional Center V recommended approval of this dedication. The Division of Safety and Emergency Management is in agreement with the proposed dedication of the right-of-way.

RECOMMENDED: That The School Board of Miami-Dade County, Florida authorize the Chair and Secretary to execute the necessary documents to dedicate vacant land to Miami-Dade County for a right-of-way purposes, as described above.

AB:rr

EXHIBIT "A"

LEGAL DESCRIPTION

That portion of the South ½ of Tract 17, of MIAMI EVERGLADES LAND CO. SUBDIVISION, in section 20, Township 54 South, Range 39 East, Dade County, Florida, according to the plat thereof, as recorded in Plat Book 2 at Page 3 of the Public Records of Miami-Dade County, Florida, which lies within the East 40 feet of the Northeast ¼ of said Section 20, less the North 20 feet thereof.

LOCATION MAP

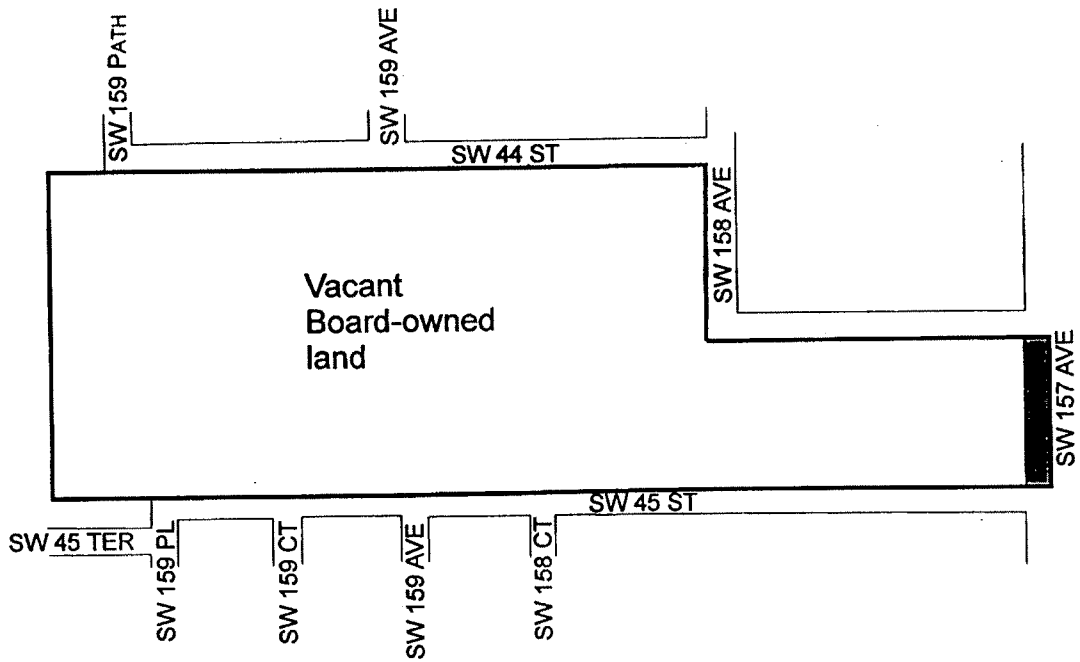

Legend

■ Proposed Right of Way
(NOT TO SCALE)

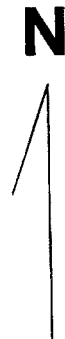

Vacant Board-owned land
AB-JG
334