

Facilities Planning and Construction  
Paul J. Phillips, Chief Facilities Officer

**SUBJECT: DEDICATION OF RIGHT-OF-WAY ADJACENT TO FELIX VARELA  
SENIOR HIGH SCHOOL**

The District is constructing Felix Varela Senior High School, located at S.W. 96 Street and S.W. 152 Avenue. In order to comply with the terms and conditions of the Miami-Dade County Developmental Impact Committee's Executive Council Final Conditions, the County has requested that the District dedicate portions of the Board-owned property for right-of-way improvement purposes (see attached location map).

The proposed dedication consists of 43' of land along both the eastern and southern boundaries of the school site.

The lands to be dedicated to Miami-Dade County are legally described as:

A portion of land lying and being at the NW 1/4 of Section 4, Township 55 South Range 39 East, Dade County, Florida; being more particularly described as follows:

Commencing at a point known as the center of Section 4, Township 55 South, Range 39 East of Dade County, Florida; also being the point of beginning, run along the south line of the NW 1/4 of said section and also being the north right of way line of S.W. 96<sup>th</sup> Street with a bearing of N87°44'45"E for 1361.73 feet; thence N00°26'28"W for 43.02 feet; thence run parallel to the south line of the NW 1/4 of said section with a bearing of N87°44'44"E for 1293.92 feet to a point of curvature; thence northwesterly along a circular curve to the left having a radius of 25.00 feet and a central angle of 88°40'33" for an arc distance of 38.69 feet; thence N00°55'48"W for 1217.63 feet; thence N87°44'45"E for 43.01 feet; thence run along the east line of the NW 1/4 of said section also being the west right of way line of S.W. 152<sup>nd</sup> Avenue with a bearing of S00°55'48"E for 1285.07 feet to the point of beginning.

Containing 112,082 square feet or 2.57 acres, more or less.

The right-of-way document has been reviewed by the School Board Attorney's Office and the Office of Risk and Benefits Management. Facilities Planning and Construction and the Region Superintendent for Region VI recommend approval of the dedication. The Department of Safety, Environment and Hazards Management is in agreement with the proposed dedication of right-of-way.

**RECOMMENDED:**

That The School Board of Miami-Dade County, Florida, authorize the Chair and the Secretary to execute the necessary documents to complete the right-of-way dedication for Felix Varela Senior High School.

AAD:adc

# LOCATION MAP

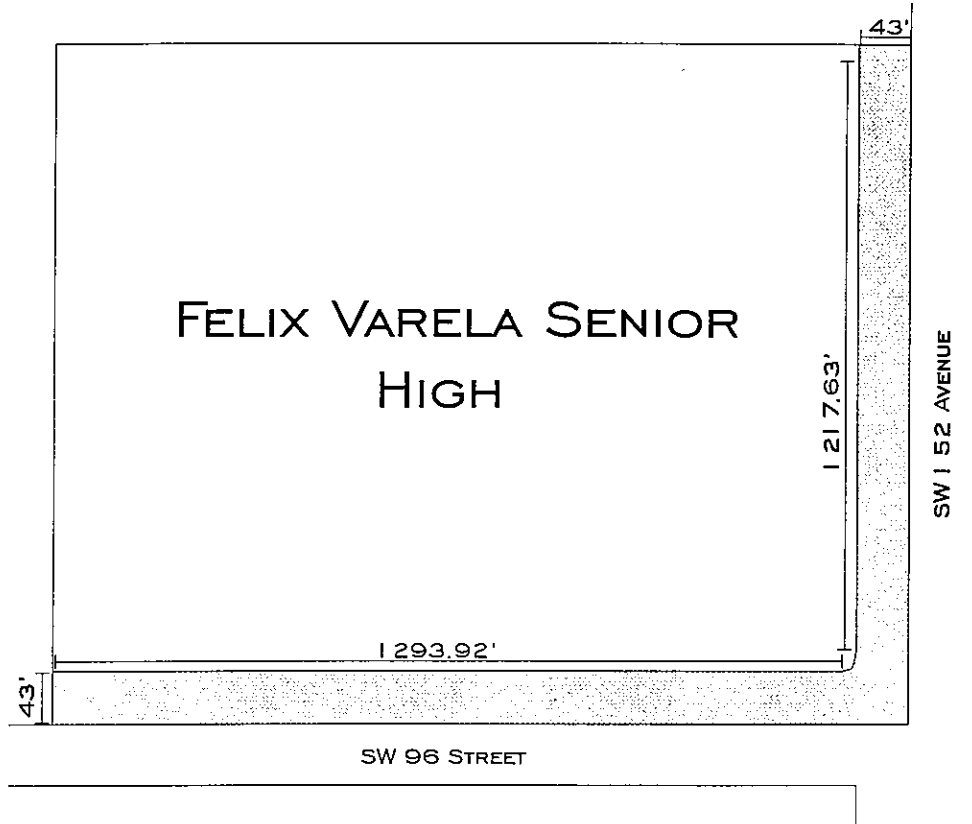

**LEGEND**

 AREA TO BE DEDICATED BY BOARD

