

Office of School Facilities  
Jaime G. Torrens, Chief Facilities Officer

**SUBJECT: AUTHORIZATION TO DEDICATE LAND TO MIAMI-DADE COUNTY FOR RIGHT-OF-WAY PURPOSES ADJACENT TO COCONUT PALM K-8 ACADEMY, LOCATED AT 24400 SW 124 AVENUE**

**COMMITTEE: FACILITIES AND CONSTRUCTION REFORM**

**LINK TO STRATEGIC PLAN: IMPROVE CONSTRUCTION SERVICES**

The District recently completed construction of the Coconut Palm K-8 Academy (K-8 Academy), located at 24400 SW 124 Avenue, and the facility opened for the 2008-09 school year. As a part of the project, Miami-Dade County (County) has requested that the District dedicate a portion of the Board-owned site for use as public right-of-way (SW 124 Avenue).

The area to be dedicated totals approximately 16,696 square feet, or .38 acres, more or less, and is more fully described in Exhibit "A", attached hereto.

The right-of-way document will be reviewed by the School Board Attorney's Office and the Office of Risk and Benefits Management prior to execution. The K-8 Academy Principal, South Regional Center Superintendent and the Office of School Facilities all recommend the proposed right-of-way dedication.

**RECOMMENDED:** That The School Board of Miami-Dade County, Florida, authorize the Chair and Secretary to execute the necessary documents to dedicate land to Miami-Dade County for right-of-way purposes adjacent to Coconut Palm K-8 Academy, located at 24400 SW 124 Avenue.

RL

# SKETCH TO ACCOMPANY LEGAL DESCRIPTION RIGHT OF WAY DEDICATION

THE SW 1/4 OF SECTION 24 TOWNSHIP 56 SOUTH RANGE 39 EAST.

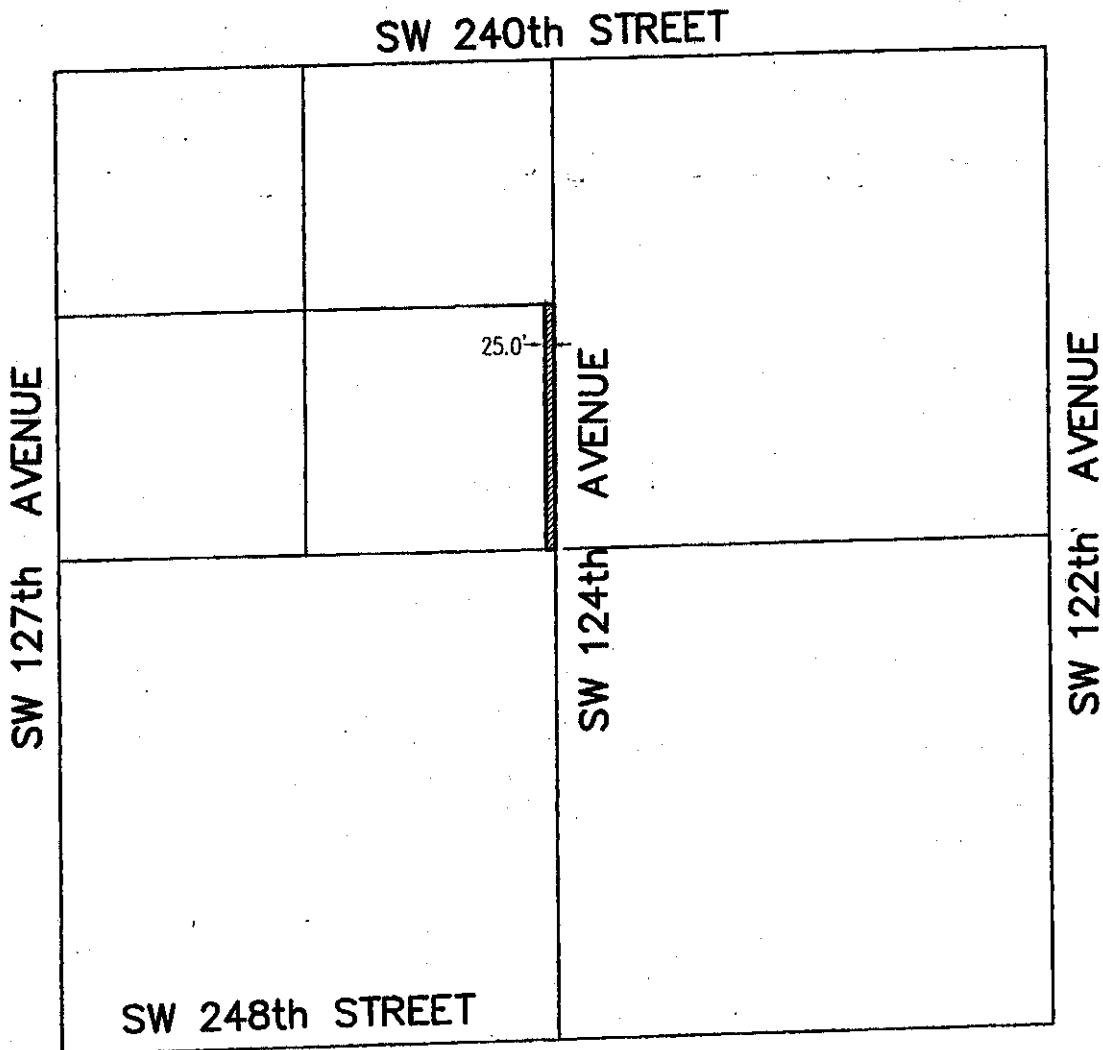

REV. 10/20/2008

THIS IS NOT A BOUNDARY SURVEY

This Description and the accompany Sketch are not valid without the signature and raised seal of a Florida Licensed Surveyor and Mapper. This Description and the accompanying Sketch are not valid one without the other.

THOMAS BROWNELL  
Executive Vice President  
Professional Land Surveyor # 2891  
State of Florida

MIAMI DADE COUNTY PUBLIC SCHOOL  
COCONUT PALM K-8 STATE SCHOOL CC 1

**E.R. BROWNELL & ASSOC., INC.**  
CONSULTING ENGINEERS LAND SURVEYORS  
2434 S.W. 28 Lane Miami, Florida, 33145  
PH: 305.860.3866 FAX: 305.860.3870

Draw By: AA Date: 07-25-08

SHEET I OF 2 Job #: 55860-AS1 Scale: 1"=500'

Certificate of Authorization No: LB 761 Sk No.: SM-2260

**EXHIBIT "A"**

Date July 25, 2008  
SHEET 2 OF 2

REV. 10/20/2008

The East 25.00 feet of the Southeast  $\frac{1}{4}$ , of the Northwest  $\frac{1}{4}$ , of the Southwest  $\frac{1}{4}$ , of Section 24, Township 56 South, Range 39 East, Lying and being situated in Miami Dade County, Florida.

**ER BROWNELL & ASSOCIATES, INC**

This Description and the accompanying Sketch are not valid without the signature and raised seal of a Florida Licensed Surveyor and Mapper. This Description and the accompanying Sketch are not valid one without the other.