

SCHOOL BOARD CONFERENCE SESSION

ATTENDANCE ZONE RECOMMENDATIONS 2026 - 2027

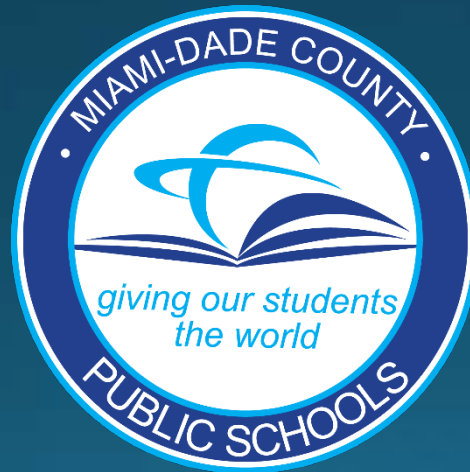

WEDNESDAY, APRIL 22, 2026



**MIAMI-DADE COUNTY PUBLIC SCHOOLS
ATTENDANCE BOUNDARY COMMITTEE (ABC) 2025-2026**



ABC APPOINTEE	APPOINTED BY	ABC ALTERNATE
The School Board of Miami-Dade County, Florida		
Mr. Eddy Barea	Ms. Mari Tere Rojas, Chair (District 6)	Ms. Cynthia Gracia
Ms. Silvia Coronado	Ms. Monica Colucci, Vice Chair (District 8)	TBA
Mr. Larry T. Williams	Dr. Steve Gallon III, Member (District 1)	Mr. Michael Horne
Ms. Regina Davis	Dr. Dorothy Bendross-Mindingall, Member (District 2)	Ms. Beverly Nixon
Ms. Lucia Baez-Geller	Mr. Joseph S. Geller, Member (District 3)	TBA
Ms. Marilyn Ruano	Mr. Roberto J. Alonso, Member (District 4)	Ms. Daissys Estrada
Ms. Angelica M. Ballestas	Mr. Danny Espino, Member (District 5)	TBA
Ms. Beatriz Pereira	Ms. Mary Blanco, Member (District 7)	TBA
Ms. Mina Hosseini	Ms. Luisa Santos, Member (District 9)	Ms. Tamia Spells
Mr. Alfred Billings	Dr. Jose L. Dotres Superintendent of Schools	Ms. Crystal Coffey
Mr. Jeffrey Codallo		Ms. Nancy Negron
Ms. Christa Dotson-Dean		Ms. Amor Reyes
Mr. Jorge L. Garcia		Ms. Rhonda Smith
Ms. Meriel Seymore		TBA
Dr. Marta Hernandez		*Educational Opportunity Access Advisory Committee (EOAAC)
Ms. Sharon Watson	Parent Teacher Association (PTA) Parent Teacher Student Association (PTSA)	Ms. Carolyn Nelson-Goedert
Ms. Beverly Heller	Educational Services and Exceptional Student Education	Mr. Ernie Martinez

Attendance Boundary Committee (ABC) Timeline at a Glance

Thursday, October 23, 2025	Orientation meeting for ABC members
Thursday, November 20, 2025	Presentation of initially targeted/advised school recommendations to ABC
Friday, November 21, 2025	Principals of initially targeted/advised schools were notified, and communications were sent to parents
Thursday, December 4, 2025	ABC identified final targeted/advised schools
Friday, December 5, 2025	Principals of final targeted/advised schools were notified
Wednesday, December 10, 2025	Regions submit community meeting dates
January 5, 2026 – January 30, 2026	Community Meetings were conducted for Targeted and Advised schools.
Thursday, February 19, 2026	ABC reviewed recommendations submitted by community/Region Offices and approved the final targeted and advised schools
Thursday, March 12, 2026	ABC boundary recommendations were presented at the Educational Opportunity Access Advisory Committee (EOAAC) meeting
Thursday, March 17, 2026	Region Superintendents present recommendations approved by the ABC to Superintendent of Schools, School Board Attorney and appropriate staff.
Wednesday, April 22, 2026	School Board Conference Session and Initial Reading for Attendance Zones 2026-2027
Wednesday, June 17, 2026	School Board Meeting - Final Reading Attendance Zones for 2026-2027

Attendance Boundary Committee (ABC) Factors Considered

1. Ability to conduct a viable educational due to declining enrollment
2. Compliance with Class Size Reduction Mandate
3. Impact on Exceptional Student Education programs
4. Use of available student stations within contiguous areas
5. Degree and extent of transportation
6. Programmatic impact due to lack of student housing
7. Reduction of the number of schools students must attend
8. Integrity of feeder systems
9. Impact of new residential developments
10. Construction of new schools
11. Impact of changes to other school boundaries

Proposed Attendance Boundary Recommendations North Region Office



Parkway Elementary School Norland Elementary School

Dr. Yesenia M. Aponte
Region Superintendent

Mr. Leonard Torres
ABC Region Director

Parkway Elementary Boundary

- 321 elementary age students live inside the Parkway Elementary Attendance Boundary area
- 129 (40%) attend Parkway Elementary School
- 28 (9%) attend Norland Elementary School

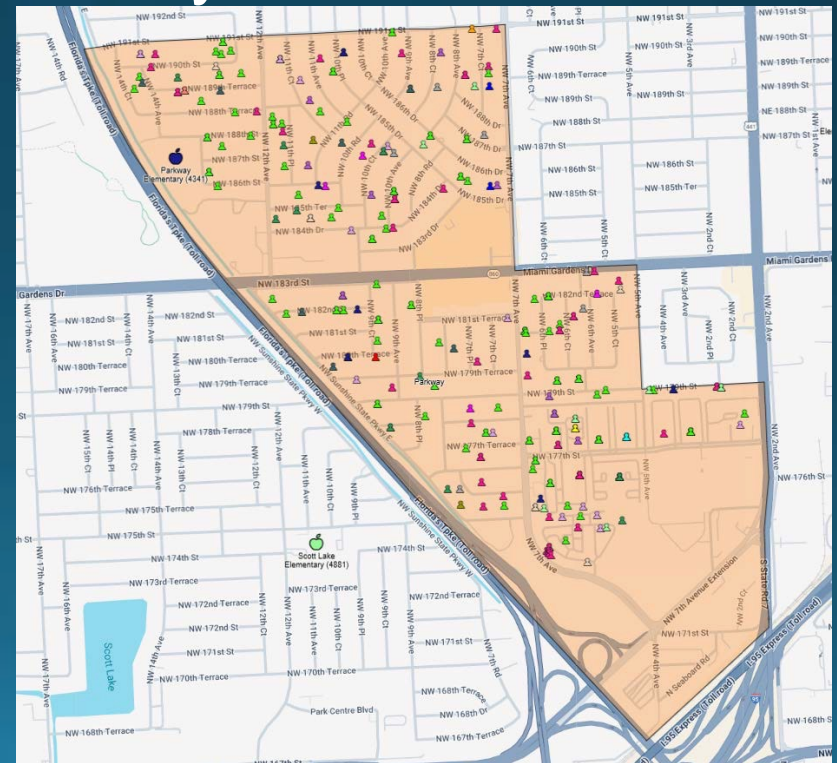

Parkway Elementary School Boundary Analysis

Grades K-5 Students Living within Boundary

Residing: 321

School Name (Enrolled)	Count	%
Parkway Elementary (4341)	129	40.19%
Norland Elementary (3701)	29	9.03%
Norwood Elementary (4001)	25	7.79%
Scott Lake Elementary (4881)	21	6.54%
Excelsior Charter Academy (5032)	17	5.3%
Crestview Elementary (1161)	9	2.8%
N. Dade Ctr For Modern Lang (5131)	8	2.49%
Joella C. Good Elementary (2181)	6	1.87%
Kipp Miami - Liberty City (2332)	6	1.87%
Bridgeprep Acad. Miami Gardens (0026)	5	1.56%
Bunche Park Elementary (0641)	5	1.56%
Hibiscus Elementary (2401)	5	1.56%
Hive Preparatory School (1014)	5	1.56%

Norland Elementary Boundary

- 892 elementary age students live inside the Norland Elementary Attendance Boundary area
- 352 (39%) attend Norland Elementary School
- 5 (<1%) attend Parkway Elementary School

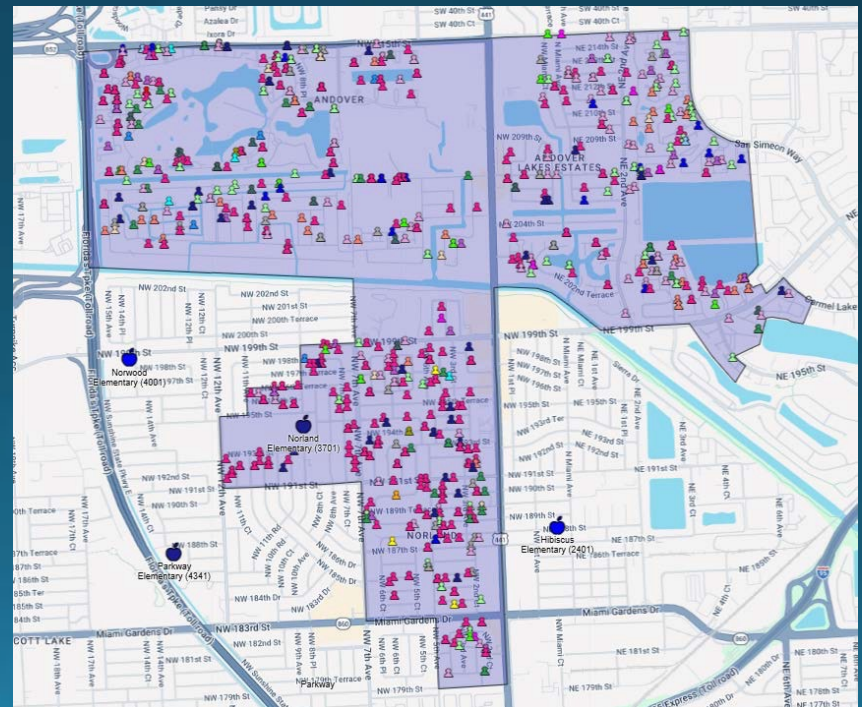

Enrollment

Parkway Elementary School Enrollment Trend Analysis

GRADE LEVEL	2024 - 2025	2025 - 2026
K	22	12
1	28	24
2	20	23
3	37	26
4	28	28
5	26	29
TOTAL	161	142
Exiting Cohort	26	-14
Incoming Cohort	12	

UTILIZATION & CAPACITY	ENROLLMENT	PERCENT UTILIZATION (CAPACITY: 478)
20-21	250	52.3%
21-22	230	48.1%
22-23	216	45.2%
23-24	216	45.2%
24-25	178	37.2%
25-26	138*	28.9%*

Enrollment Data: ARDA, Capacity Data: FISH Reports
* PARI 3/30/2026

*Data pulled from February 2025 & February 2026 FTE Surveys

Impact

Due to declining enrollment and the ability to conduct a viable educational program, the following recommendations are proposed

- Dissolve the current boundary for Parkway Elementary School.
- Combine the boundaries of Norland Elementary School and Parkway Elementary School.
- Establish new boundaries for Norland Elementary School.

Impact

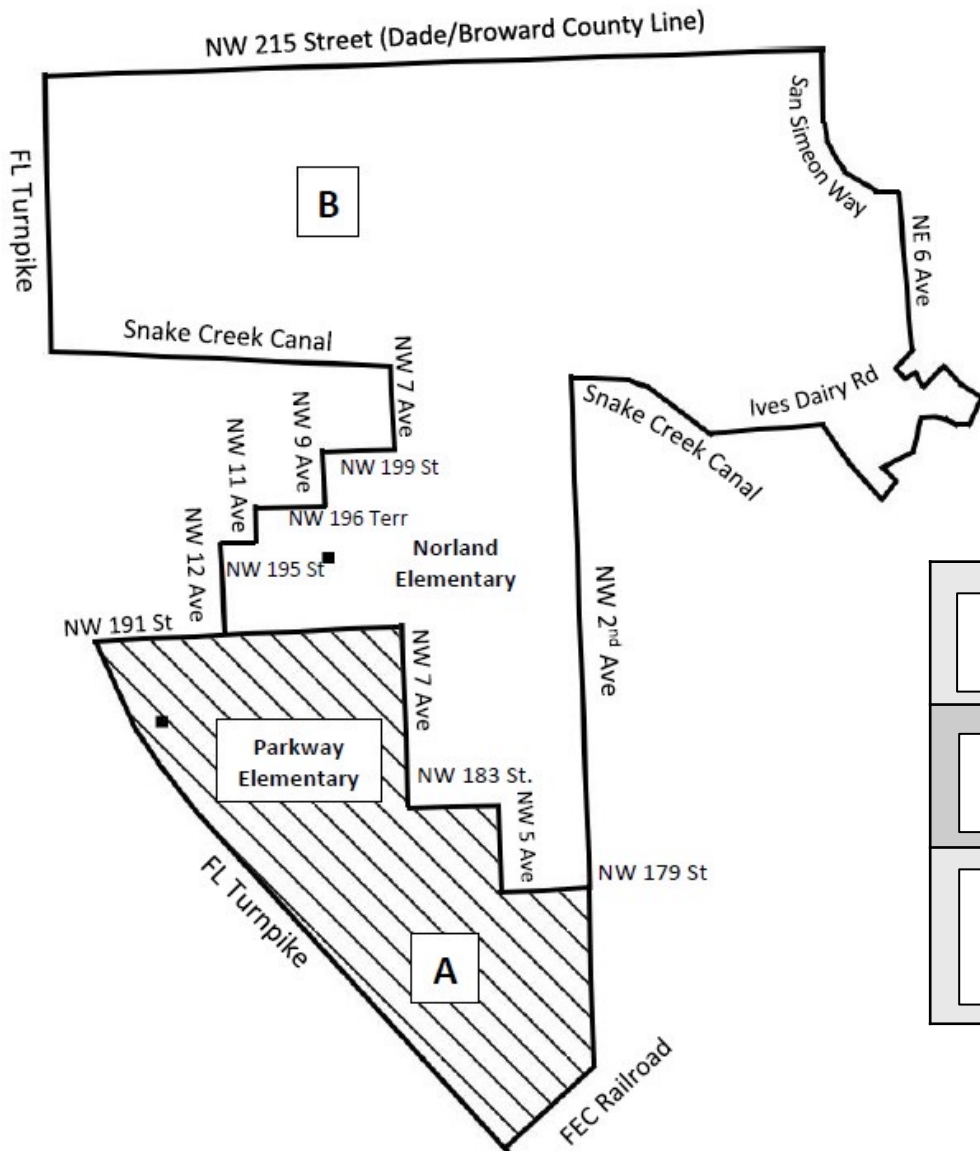

A	Area A represents the current boundary for Parkway Elementary.
B	Area B represents the current boundary for Norland Elementary.
A B	Areas A and B represent the proposed new boundary for Norland Elementary.

Current Boundaries

Assigned current boundary for Parkway Elementary School

- Begin at Florida Turnpike and NW 191 Street
- East to NW 7 Avenue
- South to NW 183 Street
- East to NW 5 Avenue
- South to NW 179 Street
- East to NW 2 Avenue
- South to FEC Railroad
- Southwest to Florida Turnpike
- Northwest to NW 191 Street,
point of beginning.

Current Boundaries

Assigned current boundary for Norland Elementary School

- Begin at Sunshine State Parkway and NW 215 Street (Dade/Broward County Line)
- East to San Simeon Way
- Southeast to NE 6 Avenue extended
- South to Snake Creek Canal
- Northwest along canal to NW 2 Avenue
- South to NW 179 Street
- West to NW 5 Avenue
- North to NW 183 Street
- West to NW 7 Avenue
- North to NW 191 Street
- West to NW 12 Avenue
- North to NW 195 Street
- East to NW 11 Avenue
- North to NW 196 Terrace
- East to NW 9 Avenue
- North to NW 199 Street
- East to NW 7 Avenue
- North to Snake Creek Canal
- West to Florida Turnpike
- North to NW 215 Street (Dade/Broward County Line),
point of beginning.

Recommended Boundaries

Proposed boundary for Norland Elementary School

- Begin at Florida Turnpike and NW 215 Street (Dade/Broward County Line)
- East to San Simeon Way
- Southeast to NE 6 Avenue extended
- South to Ives Dairy Road
- East to Carmel Lake Road
- Along Carmel Lake Rd to NE 6 Court
- Southwest to NE 195 Street (lake)
- North to Ives Dairy Road
- West to Snake Creek Canal
- Northwest along canal to NW 2 Avenue
- South to FEC Railroad
- Southwest to Florida Turnpike
- Northwest to NW 191 Street,
- East to NW 12 Avenue
- North to NW 195 Street
- East to NW 11 Avenue
- North to NW 196 Terrace
- East to NW 9 Avenue
- North to NW 199 Street
- East to NW 7 Avenue
- North to Snake Creek Canal
- West to Florida Turnpike
- North to NW 215 Street (Dade/Broward County Line),
point of beginning.

Effects

Beginning with the 2026-2027 School Year:

- New boundaries will be established for Norland Elementary School to include the Parkway Elementary School boundary (Area A).
- Norland Elementary will be the new boundary elementary school for students in K-5 residing in area A.
- Approximately 106 rising 1st through 5th grade students, currently attending Parkway Elementary and residing in Area A, may attend Norland Elementary School.
- Nine rising 1st through 5th grade students attending Parkway Elementary residing outside of the school boundary will have the option to attend Norland Elementary School.
- Norland Elementary will have new boundaries.
- Middle School boundaries will remain the same.
- High School boundaries will remain the same.

Effects

Miami-Dade County Public Schools Attendance Boundary Committee (ABC) Capacity Membership Data

3701 Norland Elementary

Capacity Membership	Current 2025-2026	Projected 2026-2027	Projected 2027-2028
Grade Configuration	PK - 5	PK - 5	PK - 5
Student Enrollment	484	593	563
Perm FISH Cap	708	708	708
% Utilization Perm FISH Cap	68%	84%	80%
Perm & Temp FISH Cap	708	708	708
% Utilization Perm & Temp	68%	84%	80%

Effects

- Norland Elementary's building student capacity is larger than Parkway Elementary. It can accommodate 708 students.
- Norland Elementary is a B rated school offering a full-time gifted program.
- Norland Elementary offers a variety of extracurricular clubs such as:
 - STEAM
 - Robotics Club
- Norland Elementary offers a multitude of Leadership and Character Programs such as:
 - 5000 Role Models of Excellence
 - ButterF.L.Y. Girls Self-Esteem Program
 - Florida Educators of America - F.E.A.
 - Care Bear Wellness Champions (Social Emotional Wellness Club)
 - Norland Bears Headline News Broadcasting/Anchor Team
 - Positive Behavior Support
 - Do the Right Thing Acknowledgement Program
- Norland Elementary offers free After-care for the first 90 students to register

Proposed Attendance Boundary Recommendations North Region Office



Rainbow Park Elementary School
Bunche Park Elementary School

Dr. Robert B. Ingram Elementary School

Dr. Yesenia M. Aponte
Region Superintendent

Mr. Leonard Torres
ABC Region Director

Rainbow Park Elementary Boundary

- 298 elementary age students live inside the Rainbow Park Elementary Attendance Boundary area
- 105 attend Rainbow Park Elementary
- 35% of area students



Rainbow Park School Boundary Analysis

Grades K-5 Students Living within Boundary

Residing: 298

School Name (Enrolled)	Count	%
Rainbow Park Elementary (4541)	105	35.23%
Dr. Robert B. Ingram El (4121)	19	6.38%
Bunche Park Elementary (0641)	14	4.7%
Amelia Earhart Elementary (1521)	12	4.03%
Mater Academy (0100)	10	3.36%
Palm Springs Elementary (4261)	9	3.02%
Excelsior Charter Academy (5032)	8	2.68%
Kipp Miami - Liberty City (2332)	8	2.68%
Nathan Young Elementary (5971)	8	2.68%
Scott Lake Elementary (4881)	8	2.68%

Enrollment

Rainbow Elementary School Enrollment Trend Analysis

GRADE LEVEL	2024 - 2025	2025 - 2026
K	25	19
1	21	26
2	38	17
3	26	33
4	23	24
5	26	19
TOTAL	159	138
Exiting Cohort	26	-7
Incoming Cohort	19	

UTILIZATION & CAPACITY	ENROLLMENT	PERCENT UTILIZATION (CAPACITY:542)
20-21	217	40.0%
21-22	215	39.7%
22-23	224	41.3%
23-24	196	36.2%
24-25	172	31.7%
25-26	128*	23.6%*

Enrollment Data: ARDA, Capacity Data: FISH Reports
* PARI 3/30/2026

*Data pulled from February 2025 & February 2026 FTE Surveys

Impact

Due to declining enrollment and the ability to conduct a viable educational program the following recommendations are proposed.

- Dissolve the current boundary for Rainbow Park Elementary School.
- Divide the Rainbow Park Elementary School boundary between Bunche Park Elementary and Dr. Robert B. Ingram Elementary using NW 27 Avenue as the dividing line.
- Establish new boundaries for Bunche Park and Dr. Robert B. Ingram Elementary Schools.

Recommendations

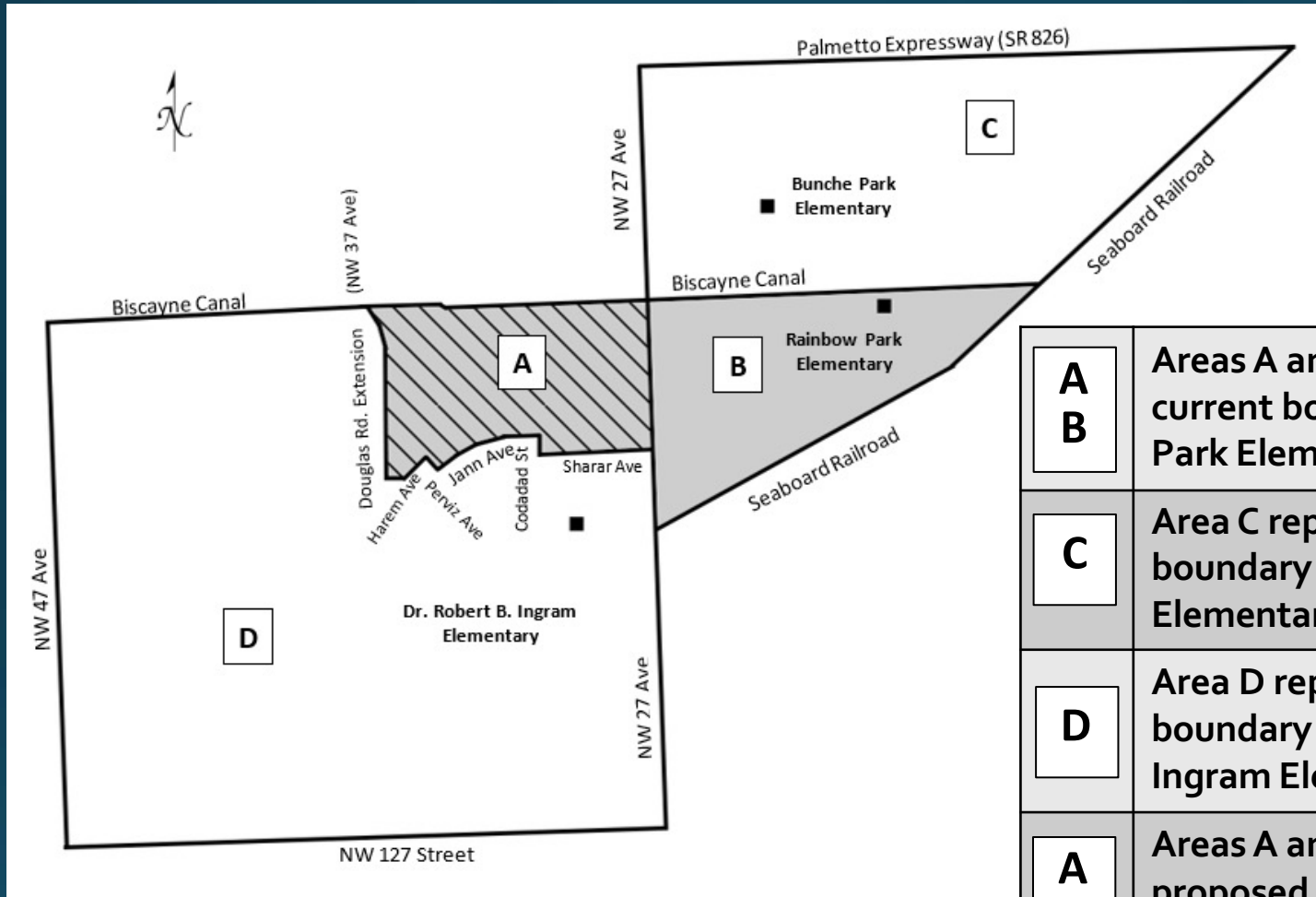

<p>A B</p>	<p>Areas A and B represent the current boundary for Rainbow Park Elementary.</p>
<p>C</p>	<p>Area C represents the current boundary for Bunche Park Elementary.</p>
<p>D</p>	<p>Area D represents the current boundary for Dr. Robert B. Ingram Elementary.</p>
<p>A D</p>	<p>Areas A and D represent the proposed new boundary for Dr. Robert B. Ingram Elementary.</p>
<p>B C</p>	<p>Areas B and C represent the proposed new boundary for Bunche Park Elementary.</p>

Current Boundaries

Assigned current boundary for Rainbow Park Elementary School

- Begin at the Biscayne Canal and the Seaboard Railroad
- West on the Biscayne Canal to Douglas Road extended
- South to Harem Avenue
- East to Pervis
- South to Jann Avenue
- East to Codadad Street
- South to Sharar Avenue
- East to NW 27 Avenue
- South to Seaboard Railroad
- Northeast to Biscayne Canal,
point of beginning.

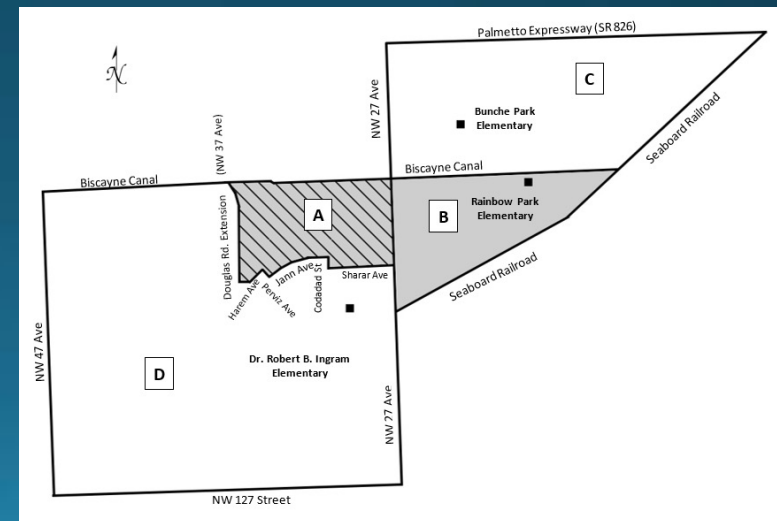

Current Boundaries

Assigned current boundary for Bunche Park Elementary School

- Begin at Palmetto Expressway (SR 826) at NW 27 Avenue
- South on NW 27 Avenue to Biscayne Canal
- East to Seaboard Railroad
- Northeast to Palmetto Expressway Interchange (SR 826)
- West on Palmetto Expressway (SR 826) to NW 27 Avenue, point of beginning.

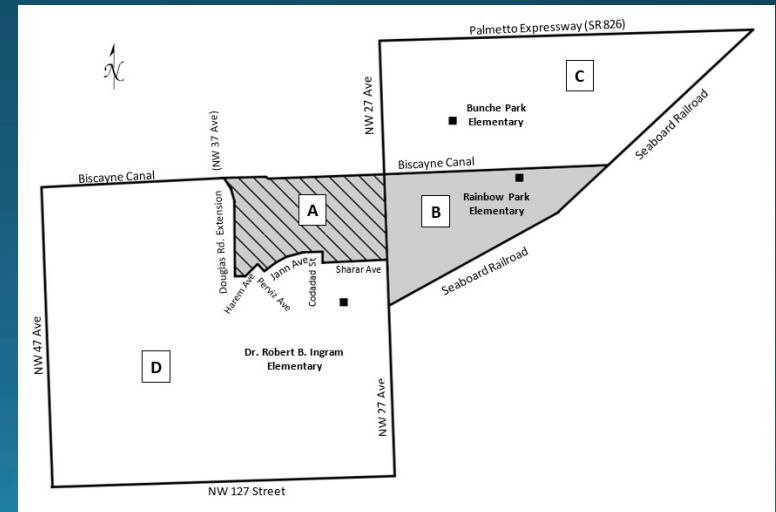

Current Boundaries

Assigned current boundary for Dr. Robert B. Ingram Elementary School

- Begin at Begin at NW 27 Avenue and Sharar Avenue
- West to Codadad Street
- North to Jann Avenue
- Southwest to Perviz
- North to Harem Avenue
- Southwest to Douglas Road Extension (approximately NW 37 Avenue)
- North to Biscayne Canal
- West to NW 47 Avenue
- South to NW 127 Street
- East to NW 27 Avenue
- North to Sharar Avenue, point of beginning.

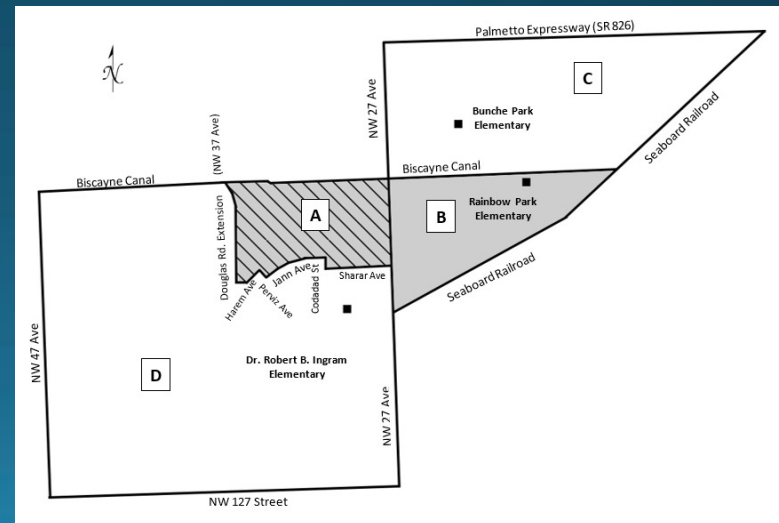

Recommended Boundaries

Proposed boundary for Bunche Park Elementary School

- Begin at Palmetto Expressway (SR 826) at NW 27 Avenue
 - South to Seaboard Railroad
 - Northeast to Palmetto Expressway (SR 826) Interchange
 - West on Palmetto Expressway (SR 826) to NW 27 Avenue,
- point of beginning.

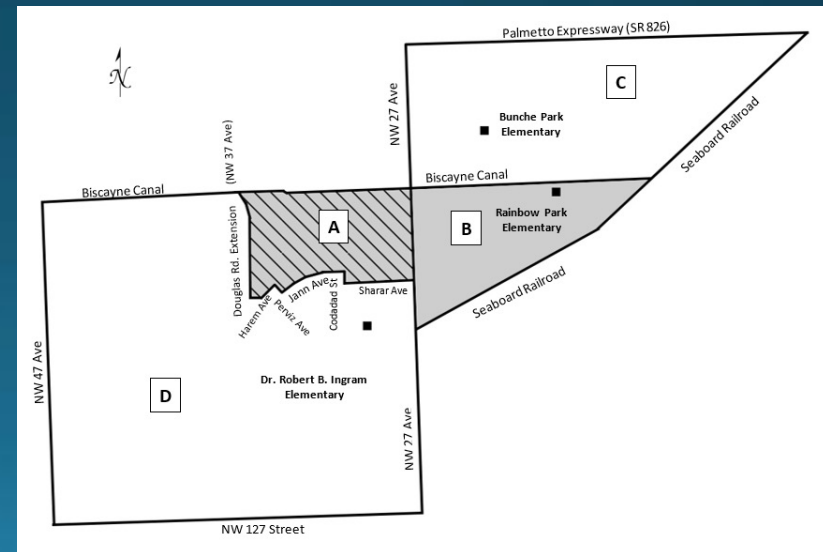

Recommended Boundaries

Proposed boundary for Dr. Robert B. Ingram Elementary School

- Begin at Begin at NW 27 Avenue and Biscayne Canal
- West to NW 47 Avenue
- South to NW 127 Street
- East to NW 27 Avenue
- North to Biscayne Canal,
point of beginning.

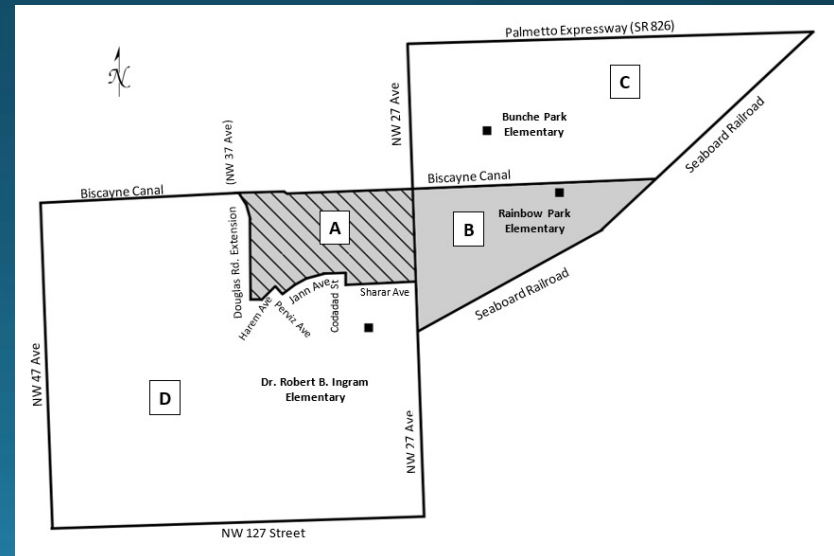

Effects

Beginning with the 2026-2027 School Year:

- New boundaries will be established for Dr. Robert B. Ingram Elementary School to include the West portion of Rainbow Park Elementary School boundary (Area A).
- Dr. Robert B. Ingram Elementary School will be the new boundary elementary school for students in K – 5 residing in Area A.
- Approximately 28 rising 1st through 5th grade students, currently attending Rainbow Park Elementary and residing in Area A, may attend Dr. Robert B. Ingram Elementary School.
- The Dance Magnet program will move to Dr. Robert B. Ingram Elementary School – Approximately 18 rising 1st through 5th grade students participating in the Dance Magnet, (11 from inside the Rainbow Park Boundary and 7 from outside the boundary), will continue in the program. Dr. Robert B. Ingram Elementary has a larger capacity, providing an opportunity for the Dance Magnet program to grow.

Effects

Beginning with the 2026-2027 School Year:

- New boundaries will be established for Bunche Park Elementary School to include the East portion of Rainbow Park Elementary School boundary (Area B).
- Bunche Park Elementary School will be the new boundary elementary school for students in K – 5 residing in Area B.
- Approximately 63 rising 1st through 5th grade students, currently attending Rainbow Park Elementary and residing in Area B, may attend Bunche Park Elementary School.
- Sixteen rising 1st through 5th grade students attending Rainbow Park Elementary but residing outside of the school boundary will have the choice option to attend Bunche Park Elementary, Dr. Robert B. Ingram Elementary.
- Middle School and High School boundaries will remain the same.

Effects

Miami-Dade County Public Schools Attendance Boundary Committee (ABC) Capacity Membership Data

4121 Dr. Robert B. Ingram Elementary

Capacity Membership	Current 2025-2026	Projected 2026-2027	Projected 2027-2028
Grade Configuration	PK-5	PK-5	PK-5
Student Enrollment	211	235	226
Perm FISH Cap	558	558	558
% Utilization Perm FISH Cap	38%	42%	41%
Perm & Temp FISH Cap	558	558	558
% Utilization Perm & Temp	38%	42%	41%

Effects

Miami-Dade County Public Schools Attendance Boundary Committee (ABC) Capacity Membership Data

0641 Bunche Park Elementary

Capacity Membership	Current 2025-2026	Projected 2026-2027	Projected 2027-2028
Grade Configuration	PK-5	PK-5	PK-5
Student Enrollment	249	339	327
Perm FISH Cap	388	388	388
% Utilization Perm FISH Cap	64%	87%	84%
Perm & Temp FISH Cap	388	388	388
% Utilization Perm & Temp	64%	87%	84%

Effects

- Dr. Robert B. Ingram Elementary is a B rated school offering a gifted program.
- Dr. Robert B. Ingram Elementary offers two after school programs and extended learning opportunities.
- Dr. Robert B. Ingram Elementary offers a variety of extracurricular clubs such as:
 - 5000 Role Models
 - Young Ladies of Royalty
 - Chess
 - Dance
 - Legos

Effects

- Bunche Park Elementary offers an ASD Program K-5.
- Bunche Park Elementary offers after school care and extended learning opportunities.
- Bunche Park Elementary offers a variety of extracurricular clubs such as:
 - STEM
 - Mentorship & Tutoring
 - Drama & Dance Club

Proposed Attendance Boundary Recommendations Central Region Office



**Georgia Jones-Ayers
Middle School**



**Lenora B. Smith
Elementary School**



Georgia Jones-Ayers Middle School Lenora B. Smith Elementary School

Ms. Brenda Swain
Region Superintendent

Mr. Manuel S. Garcia
ABC Region Director

Boundary Analysis

Lenora B. Smith Elementary School

- 474 elementary age students live inside the Attendance Boundary
 - 210 attend Lenora B. Smith Elementary School
 - 44.3% of area students

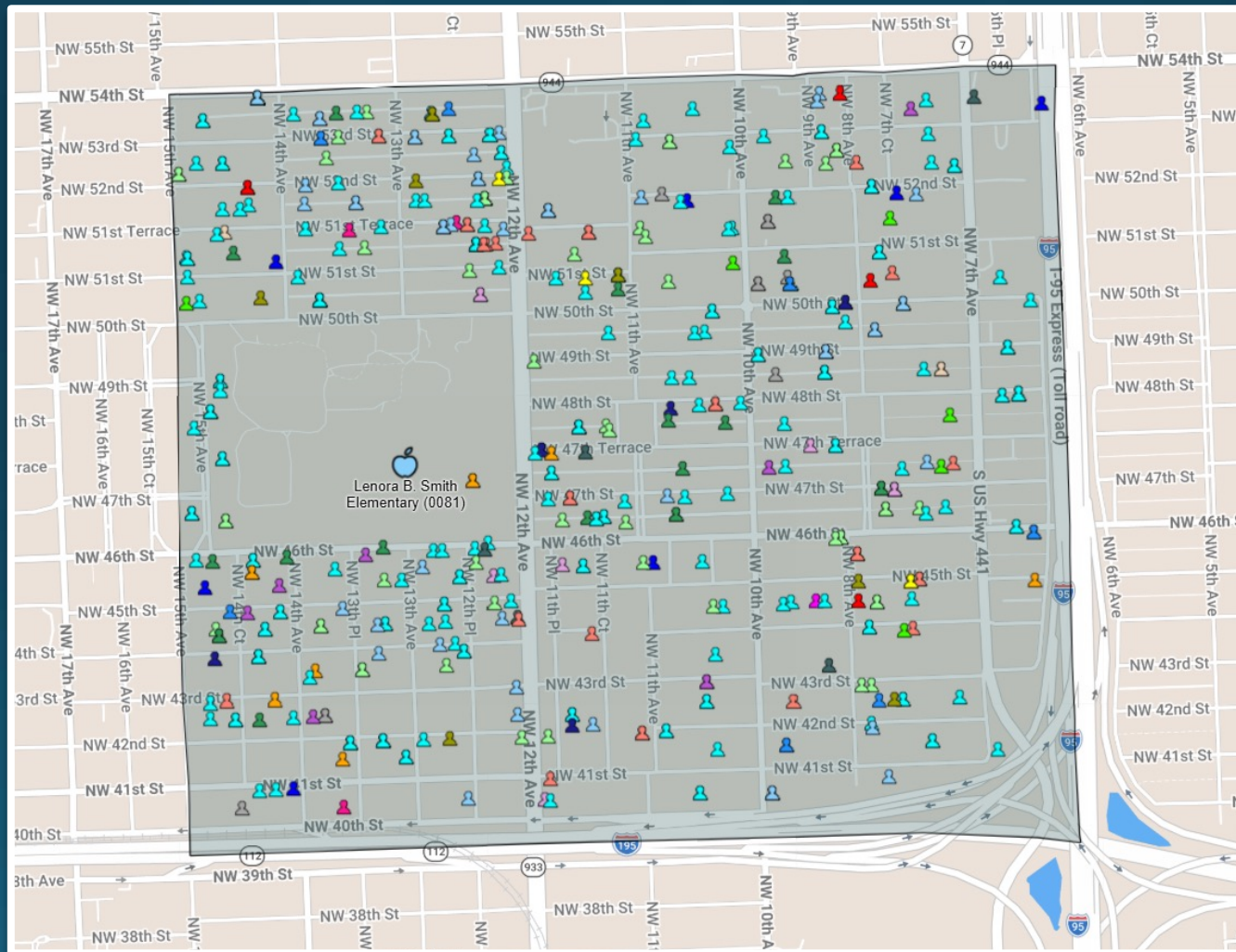

Boundary Analysis

Lenora B. Smith Elementary School

474 PreK – 5th Grade Students in Boundary

School Name (Enrolled in Boundary)	Count	%
Lenora B. Smith Elementary (0081)	210	44.30%
Mater Academy Of Intl Studies (1017)	33	6.96%
Agenoria S. Paschal/Olinda El (4071)	18	3.80%
Orchard Villa Elementary (4171)	15	3.16%
Dr. Charles R. Drew K-8 Center (1401)	14	2.95%
Kipp Miami - Liberty City (2332)	11	2.32%
Comstock Elementary (0881)	10	2.11%
Kelsey L. Pharr Elementary (4401)	10	2.11%
Santa Clara Elementary (4841)	10	2.11%
Downtown Miami Charter School (3600)	7	1.48%
Ipreparatory Academy (7581)	7	1.48%
Mater Preparatory Academy (3003)	7	1.48%
Melrose Elementary (3181)	7	1.48%
Arcola Lake Elementary (0101)	6	1.27%
Bridgeprep. Acad. Greater Miami (2013)	6	1.27%
Lincoln-Marti Cs Little Havana (5025)	6	1.27%

Snapshot of highest enrolling schools.

Source: Frontline/Location Analytics, 03/13/26

Enrollment

Lenora B. Smith Elementary School Enrollment Trend Analysis

GRADE LEVEL	2024 - 2025	2025 – 2026
K	42	30
1	38	40
2	48	32
3	71	52
4	56	56
5	66	46
TOTAL	321	256
Exiting Cohort	65	-46
Incoming Cohort	19	

UTILIZATION & CAPACITY	ENROLLMENT	PERCENT UTILIZATION (CAPACITY: 754)
20-21	404	53.6%
21-22	358	47.5%
22-23	367	48.7%
23-24	341	45.2%
24-25	353	46.8%
25-26	256	36.5%

Enrollment Data: ARDA, Capacity Data: FISH Reports

*Data pulled from February 2025 & February 2026 FTE Surveys

Impact

Due to the declining enrollment over the past five years and the underutilization of both Georgia Jones-Ayers Middle School and Lenora B. Smith Elementary School, the following recommendation is proposed:

- Dissolve the current Georgia Jones-Ayers Middle School boundary.
- Combine Georgia Jones-Ayers Middle School and Lenora B. Smith Elementary School as a K-8 Center.

Recommended Boundaries

Georgia Jones-Ayers Middle School 1331 NW 46th St. Miami, FL 33142	Lenora B. Smith Elem School 4700 NW 12th Ave. Miami, FL 33127	Brownsville Middle School 4899 NW 24th Ave. Miami, FL 33142	Jose De Diego Middle School 3100 NW 5th Ave. Miami, FL 33127
---	--	--	---

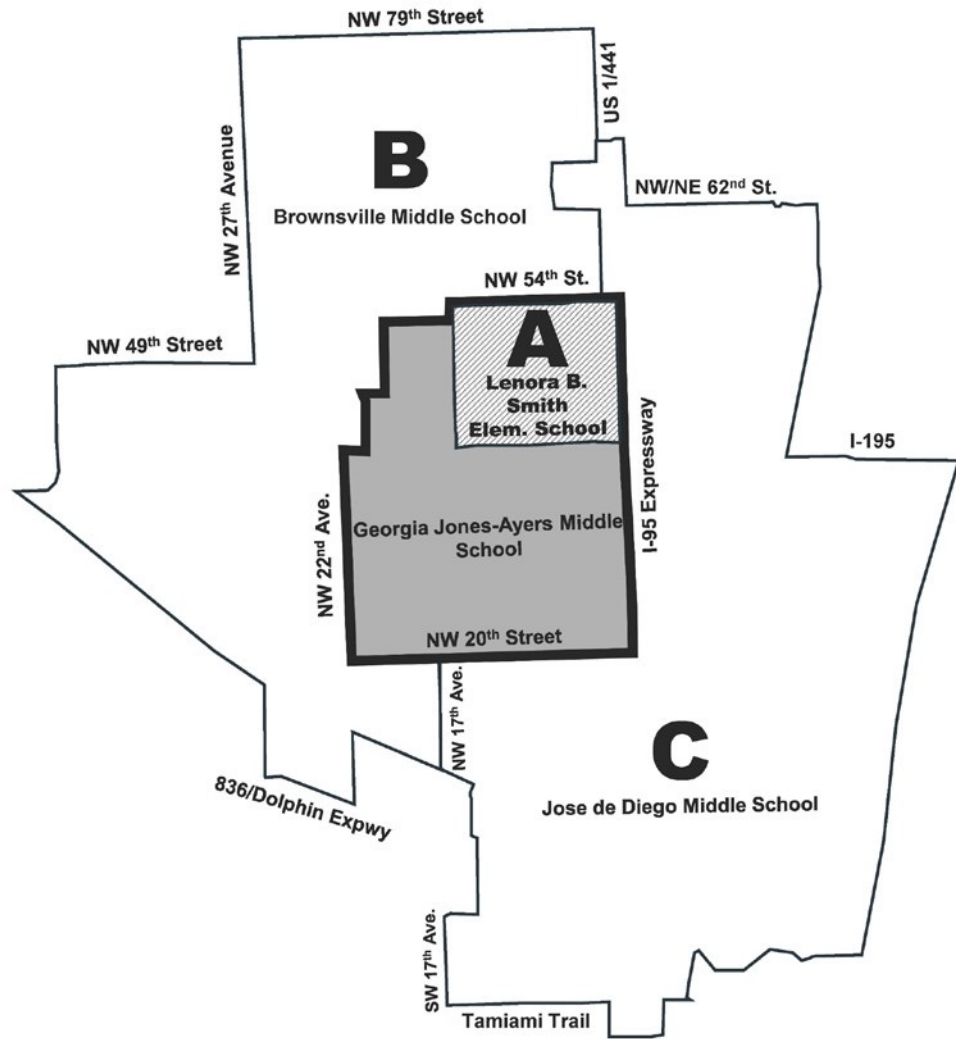

Current Georgia Jones-Ayers Middle School Attendance Boundary
A Current Lenora B. Smith Elem. School Attendance Boundary
B Current Brownsville Middle Attendance Boundary
C Current Jose de Diego Middle Attendance Boundary

Current Boundary

Lenora B. Smith Elementary School

Begin at NW 15 Avenue and NW 54 Street

- East on NW 54 Street to I-95
- South on I-95 to State Road 112
- West on State Road 112 to NW 15 Avenue
- North on NW 15 Avenue to NW 54 Street,
point of beginning.

Current Boundary

Georgia Jones-Ayers Middle School

Begin at North-South Expressway (I-95) and NW 54 Street

- South to NW 20 Street
- West to NW 22 Avenue
- North to Airport Expressway (112)
- East to NW 21 Avenue
- North to NW 46 Street
- East to NW 19 Avenue
- North to NW 52 Street
- East to NW 15 Avenue
- North to NW 54 Street
- East to North-South Expressway (I-95),
point of beginning.

Effects

Beginning with the 2026-2027 School Year:

- Combine Georgia Jones-Ayers Middle School and Lenora B. Smith Elementary School as a K-8 Center.
- All current elementary students in the Georgia Jones-Ayers boundary may attend Georgia Jones-Ayers/Lenora B. Smith K-8 Center.
- All current 6th and 7th grade students attending Georgia Jones-Ayers Middle School may attend Georgia Jones-Ayers/Lenora B. Smith K-8 Center.
- All middle grade students (6th – 8th) residing in the George Jones-Ayers/Lenora B. Smith K-8 boundary will have the option to attend George Jones-Ayers/Lenora B. Smith K-8 for grades 6th – 8th or may attend the boundary residence middle school.
- Preserve both names, Georgia Jones-Ayers & Lenora B. Smith, as a combined name, Georgia Jones-Ayers/Lenora B. Smith K-8 Center, as recommended from community feedback.

Effects

Beginning with the 2026-2027 School Year:

**Miami-Dade County Public Schools
Attendance Boundary Committee (ABC)
Capacity Membership Data**

Georgia Jones-Ayers/Lenora B. Smith K8 Center

Capacity Membership	Current 2025-2026	Projected 2026-2027	Projected 2027-2028
Grade Configuration	Middle School (6-8)	K8 Center (PK-8)	K8 Center (PK-8)
Student Enrollment	448	701	680
Perm FISH Cap	1154	1154	1154
% Utilization Perm FISH Cap	38.82	60.74%	58.92%
Perm & Temp FISH Cap	1154	1154	1154
% Utilization Perm & Temp	38.82	60.74%	58.92%

Proposed Attendance Boundary Recommendations Central Region Office



**Phillis Wheatley
Elementary School**

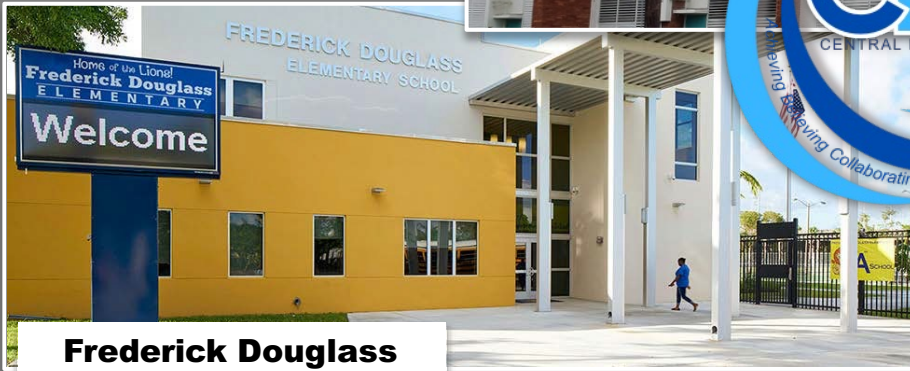

**Frederick Douglass
Elementary School**



**Paul L. Dunbar
K-8 Center**



CENTRAL REGION OFFICE

Building Collaborating

Phillis Wheatley Elementary School
Frederick Douglass Elementary School **Paul L. Dunbar K-8 Center**

Ms. Brenda Swain
Region Superintendent

Mr. Manuel S. Garcia
ABC Region Director

Boundary Analysis

Phillis Wheatley Elementary School

- 837 elementary age students live inside the Attendance Boundary
 - 132 attend Phillis Wheatley Elementary School
 - 15.77% of area students

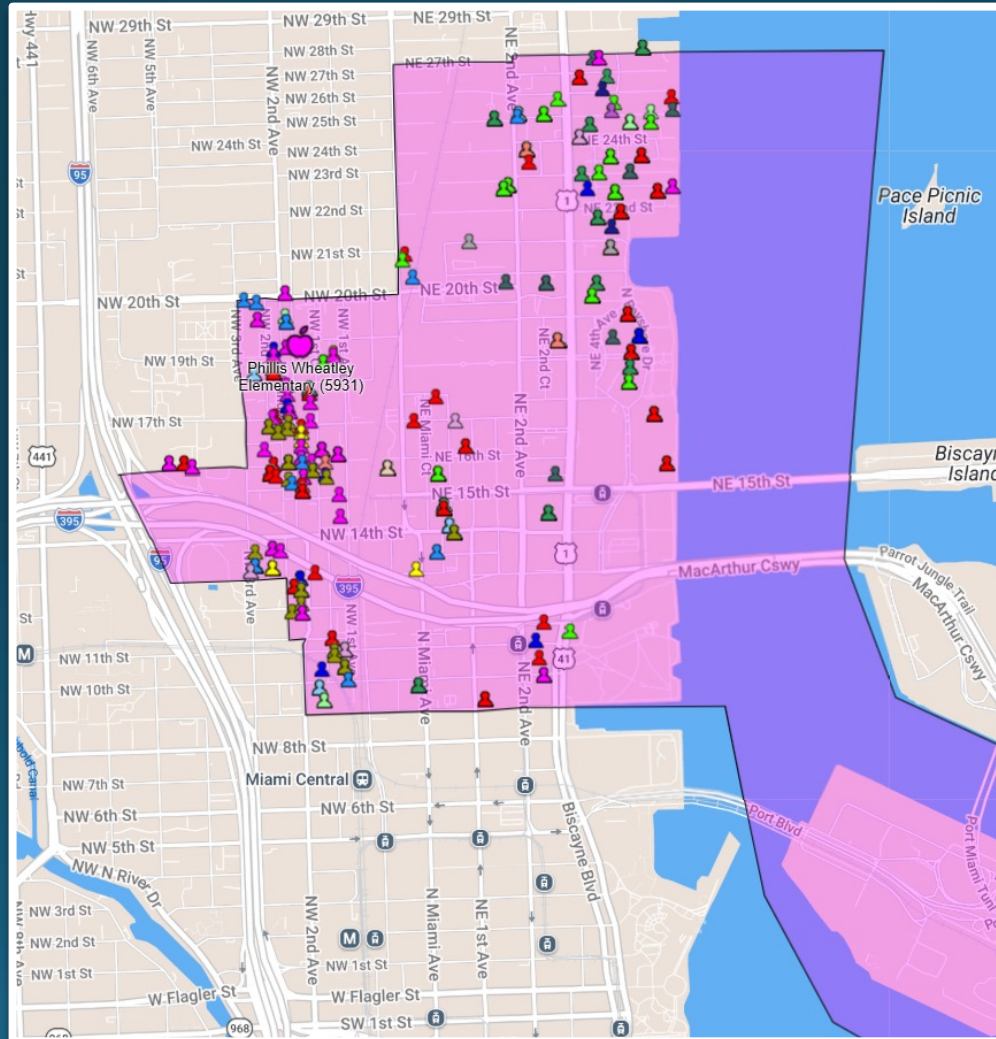

Boundary Analysis

Phillis Wheatley Elementary School

837 PreK – 5th Grade Students in Boundary

School Name (Enrolled in Boundary)	Count	%
Phillis Wheatley Elementary (5931)	132	15.77%
Bridgeprep Acad Greater Miami (2013)	106	12.66%
Miami Children's Museum (4000)	94	11.23%
Ipreparatory Academy (7581)	69	8.24%
Frederick Douglass Elementary (1361)	59	7.05%
Gibson Charter School (2060)	53	6.33%
Downtown Miami Charter School (3600)	39	4.66%
Southside Preparatory Academy (5321)	29	3.46%
Ada Merritt K-8 Center (3191)	28	3.35%
Paul Laurence Dunbar K-8 Ctr (1441)	14	1.67%
Citrus Grove K-8 Center (0801)	12	1.43%
Mater Academy East Charter (3100)	12	1.43%
Chapman Partnership Ecc North (0331)	9	1.08%
Mater Academy Of Intl Studies (1017)	9	1.08%
Mater Grove Academy (5045)	9	1.08%

Snapshot of highest enrolling schools.

Source: Frontline/Location Analytics, 03/13/26

Enrollment

Phillis Wheatley Elementary School Enrollment Trend Analysis

GRADE LEVEL	2024 - 2025	2025 – 2026
K	26	17
1	19	23
2	28	19
3	33	29
4	14	27
5	19	18
TOTAL	147	139
Exiting Cohort	19	-13
Incoming Cohort	6	

UTILIZATION & CAPACITY	ENROLLMENT	PERCENT UTILIZATION (CAPACITY: 620)
20-21	194	31.3%
21-22	190	30.6%
22-23	179	28.9%
23-24	157	25.3%
24-25	147	23.7%
25-26	139	22.4%

Enrollment Data: ARDA, Capacity Data: FISH Reports

*Data pulled from February 2025 & February 2026 FTE Surveys

Impact

Due to declining enrollment and the ability to conduct a viable educational program, the following recommendations are proposed:

- Dissolve the current boundary for Phillis Wheatley Elementary School.
- Divide the Phillis Wheatley Elementary School boundary between Frederick Douglass Elementary (Area D) and Paul L. Dunbar K-8 Center (Areas B).
- Establish new boundaries for Frederick Douglass Elementary School (Areas C & D) and Paul L. Dunbar K-8 Center (Areas A & B).

Recommended Boundaries

Phyllis Wheatley Elementary School
1801 NW 1st Pl, Miami, FL 33136

Frederick Douglass Elementary School
314 NW 12th St, Miami, FL 33136

Paul L Dunbar K-8 Center
505 NW 20th St, Miami, FL 33127

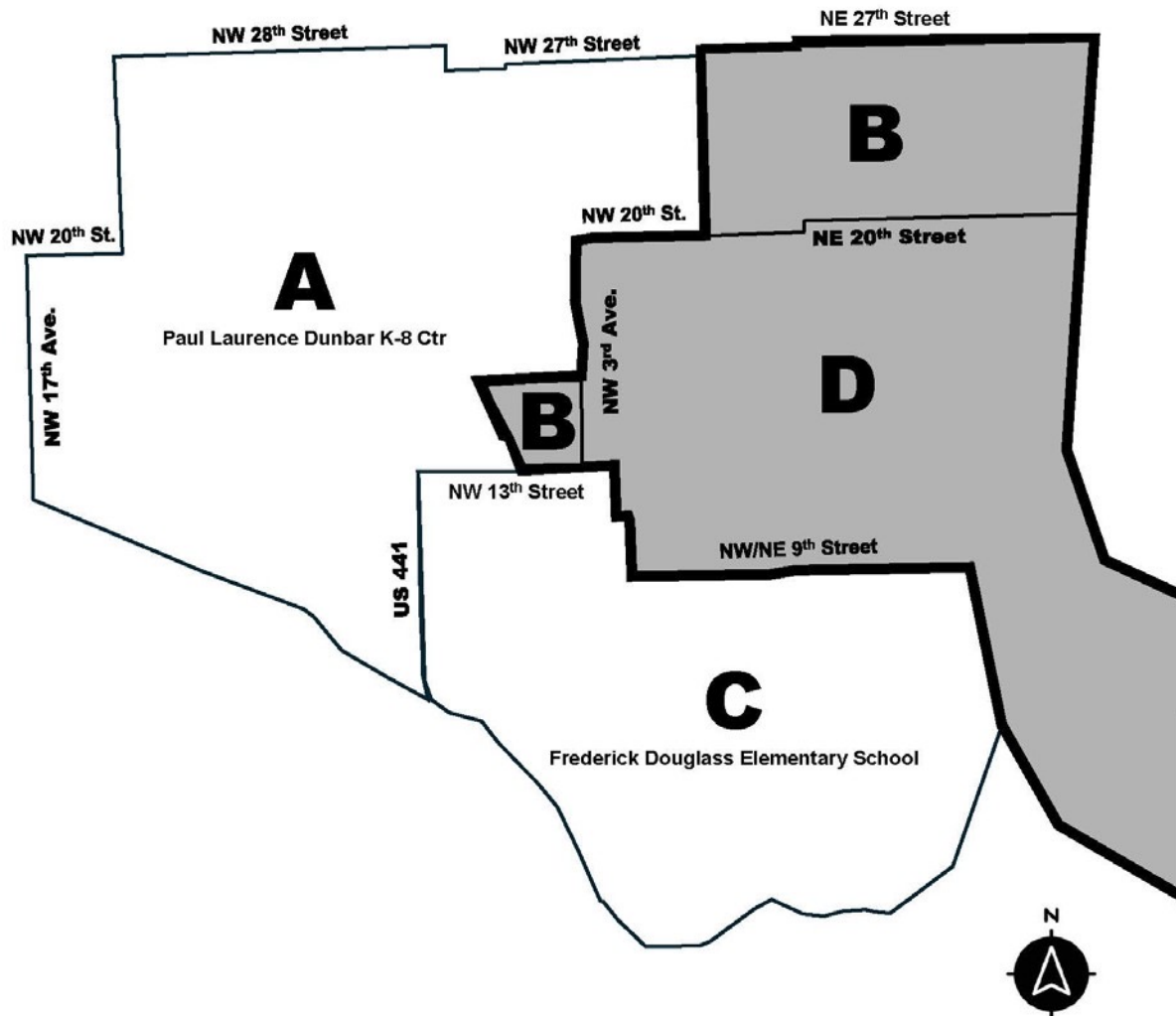

	Current Phyllis Wheatley Elem. Sch. Attendance Boundary
A	Current Paul L. Dunbar K-8 Ctr Attendance Boundary
B	Proposed Boundary Extension for Paul Lawrence Dunbar K-8 Ctr.
C	Current Frederick Douglass Elem. Attendance Boundary
D	Proposed Boundary Extension for Frederick Douglass Elem.

Current Boundary

Phillis Wheatley Elementary School

Begin at North-South Expressway (I-95) and NW 16 Street

- East to NW 3 Avenue North to NW 20 Street
- East to Miami Avenue North to NW 27 Street
- East to Biscayne Bay
- South to Government Cut and Dodge Island, encompassing all of Dodge Island
- Northwest to NE 9 Street
- West to NW 2 Avenue
- North to NW 13 Street
- West to North-South Expressway (I-95)
- North to NW 16 Street,
point of beginning.

Current Boundary

Frederick Douglass Elementary School

Begin at Biscayne Bay and NE 9 Street

- West on NE 9 Street to NW 2 Avenue
- North to NW 13 Street
- West to NW 7 Avenue
- South to the Miami River
- Southeast to North-South Expressway (I-95)
- Southeast to Biscayne Bay
- Northeast to NE 9 Street,
point of beginning.

Current Boundary

Paul Laurence Dunbar K-8 Center

Begin at NW 14 Avenue and NW 28 Street

- East on NW 28 Street to North-South Expressway (I-95)
- South to NW 27 Street
- East to Miami Avenue
- South to NW 20 Street
- West to NW 3 Avenue
- South to NW 16 Street
- West to North-South Expressway (I-95)
- South to NW 13 Street
- West to NW 7 Avenue
- South to the Miami River
- Northwest to NW 17 Avenue
- North to NW 20 Street
- East to NW 14 Avenue
- North to NW 28 Street, point of beginning.

Recommended Boundary

Proposed Boundary for Frederick Douglass Elementary School

Begin at North Miami Avenue and NE 20 Street

- East to Biscayne Bay NW 2 Avenue and NW 9 Street
- East to Biscayne Bay
- South through MacArthur Causeway
- East along MacArthur Causeway to the Eastern Most tip of Dodge Island
- West to the Miami River
- Miami River Northwest to NW 7 Avenue
- North to NW 13 Street
- East to NW 3 Avenue
- North to NW 20 Street
- East to North Miami Avenue,
point of beginning.

Recommended Boundary

Proposed Boundary for Paul Laurence Dunbar K-8 Center

Begin at NW 17 Avenue and the Miami River

- North to NW 20 Street
- East to NW 14 Avenue
- North to NW 28 Street
- East to I-95
- South to NW 27 Street
- East to Biscayne Bay
- South to NE 20 Street
- West to NW 3 Avenue
- South to NW 13 Street
- West to 441/7 Avenue
- South to The Miami River
- Miami River to NW 17 Avenue
point of beginning.

Effects

Beginning with the 2026 - 2027 School Year:

- New boundaries will be established for Frederick Douglass Elementary School and Paul L. Dunbar K-8 Center.
- In Area B, approximately eleven (11) current kindergarten through fourth grade students in the boundary of Phillis Wheatley Elementary may attend Paul L. Dunbar K-8 Center.
- In Area (D), approximately one hundred two (102) current kindergarten through fourth grade students in the boundary of Phillis Wheatley Elementary may attend Frederick Douglass Elementary.
- All students residing in the combined boundaries of Phillis Wheatley Elementary, Frederick Douglass Elementary and Paul L. Dunbar K-8 Center may attend Jose de Diego Middle School as their middle school option.

Effects

Beginning with the 2026-2027 School Year:

**Miami-Dade County Public Schools
Attendance Boundary Committee (ABC)
Capacity Membership Data**

Frederick Douglass Elementary School

Capacity Membership	Current 2025-2026	Projected 2026-2027	Projected 2027-2028
Grade Configuration	Elementary (PK – 5)	Elementary (PK – 5)	Elementary (PK – 5)
Student Enrollment	181	277	271
Perm FISH Cap	275	275	275
% Utilization Perm FISH Cap	65.81	100.7%	98.54%
Perm & Temp FISH Cap	275	275	275
% Utilization Perm & Temp	65.81	100.7%	98.54%

Effects

Beginning with the 2026-2027 School Year:

**Miami-Dade County Public Schools
Attendance Boundary Committee (ABC)
Capacity Membership Data**

Paul L. Dunbar K-8 Center

Capacity Membership	Current 2025-2026	Projected 2026-2027	Projected 2027-2028
Grade Configuration	K-8 Center (K-8)	K-8 Center (K-8)	K-8 Center (K-8)
Student Enrollment	301	310	309
Perm FISH Cap	788	788	788
% Utilization Perm FISH Cap	38.19%	39.34%	39.21%
Perm & Temp FISH Cap	788	788	788
% Utilization Perm & Temp	38.19%	39.34%	39.21%

Proposed Attendance Boundary Recommendations Central Region Office



Miami Springs Senior High School



Brownsville Middle School



Miami Springs Middle School



Kinloch Park Middle School



Henry H. Filer Middle School

Miami Springs Senior High School
Brownsville Middle School

Miami Springs Middle School

Kinloch Park Middle School
Henry H. Filer Middle School

Ms. Brenda Swain
Region Superintendent

Mr. Manuel S. Garcia
ABC Region Director

Boundary Analysis

Miami Springs Middle School

1,627 6th – 8th Grade Students n Boundary

School Name (Enrolled in Boundary)	Count	%
Miami Springs Middle (6521)	441	27.11%
Imater Academy Middle School (6014)	359	22.07%
Academy For Innovative Educ (6093)	219	13.46%
Excelsior Prep Charter School (5029)	83	5.10%
Doral Academy Charter Middle (6030)	82	5.04%
Mater Academy Charter Middle (6012)	67	4.12%
Hialeah Middle (6231)	47	2.89%
Jose Marti Mast 6-12 Academy (7291)	41	2.52%
Palm Springs Middle (6681)	23	1.41%
Henry H. Filer Middle (6171)	20	1.23%
Hialeah Gardens Middle School (6751)	20	1.23%
Doral Academy Of Technology (3029)	15	0.92%
Kipp Miami - Liberty City (2332)	12	0.74%
City Of Hialeah Education Acad (7262)	11	0.68%
Renaissance Charter School (6028)	11	0.68%
Somerset Academy Middle-South (6013)	11	0.68%

Snapshot of highest enrolling schools.

Source: Frontline/Location Analytics, 03/13/26

Enrollment

Miami Springs Middle School Enrollment Trend Analysis

GRADE LEVEL	2024 - 2025	2025 – 2026
6	199	183
7	240	179
8	221	208
TOTAL	660	570
Exiting Cohort	221	-38
Incoming Cohort	183	

**Data pulled from February 2025 & February 2026 FTE Surveys

UTILIZATION & CAPACITY	ENROLLMENT	PERCENT UTILIZATION (CAPACITY: 1307)
20-21	702	53.7%
21-22	640	49%
22-23	710	54.3%
23-24	693	53%
24-25	660	50.5%
25-26	570	43.6%

Enrollment Data: ARDA, Capacity Data: FISH reports

Impact

Due to declining student enrolment at Miami Springs Middle School and Miami Springs Senior over the past five years, both schools have a building utilization under 55%. Thus, the following recommendation is proposed:

- Dissolve the current boundary for Miami Springs Middle School.
- Divide the Miami Springs Middle School boundary between Brownsville Middle (Area B), Kinloch Park Middle (Area D), and Henry H. Filer Middle (Areas F).
- Establish Miami Springs Middle School and Miami Springs Senior High School as MSSH Preparatory Academy, a 6-12 configuration.
- Efficient use of existing physical infrastructure at Miami Springs Senior High School.

Recommended Boundaries

Miami Springs Middle School 150 S Royal Poinciana Blvd Miami Springs, FL 33166	Brownsville Middle School 4899 NW 24th Ave Miami, FL 33142	Kinloch Park Middle School 4340 NW 3rd St Miami, FL 33126	Henry H. Filer Middle School 531 W 29th St Hialeah, FL 33012
---	---	--	---

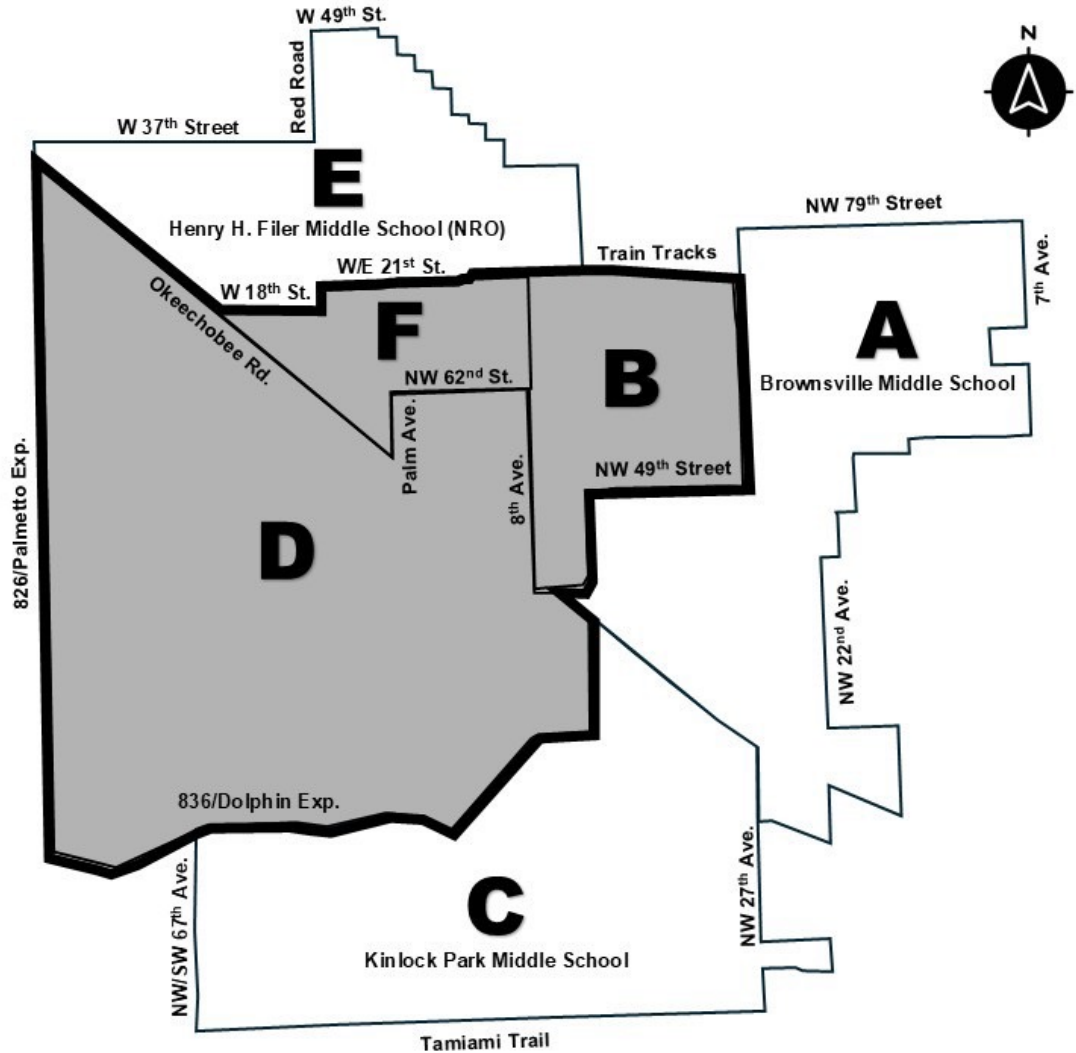

Current Miami Springs Middle Attendance Boundary	
A	Current Brownsville Middle Attendance Boundary
B	Proposed Boundary Extension for Brownsville Middle
C	Current Kinloch Park Middle Attendance Boundary
D	Proposed Boundary Extension for Kinloch Park Middle
E	Current Henry Filer Middle Attendance Boundary
F	Proposed Boundary Extension for Henry Filer Middle

Current Boundary

Miami Springs Middle School

Begin at Palmetto Expressway (SR 826) and Okeechobee Canal

- Southeast on Canal to W 18 Street, Hialeah
- East to W 4 Avenue (NW 57 Avenue)
- North to Florida East Coast Railroad
- East to NW 27 Avenue
- South to NW 49 Street
- West to Seaboard Railroad
- South to Airport Expressway (112)
- West to Miami River
- Southeast to Seaboard Railroad
- South to Tamiami Canal
- West and Southwest to Dolphin Expressway (SR836)
- West to Palmetto Expressway (SR 826)
- North to Okeechobee Canal,
point of beginning.

Current Boundary

Brownsville Middle School

Begin at NW 27 Avenue and NW 79 Street (SR934)

- East to NW 7 Avenue
- South to NW 67 Street
- West to NW 10 Avenue
- South to NW 62 Street
- East to NW 7 Avenue (SR441)
- South to NW 54 Street (SR944)
- West to NW 15 Avenue
- South to NW 52 Street
- West to NW 19 Avenue
- South to NW 46 Street
- West to NW 21 Avenue
- South to Airport Expressway (SR112)
- West to NW 22 Avenue
- South to NW 20 Street
- East to NW 17 Avenue
- South to Miami River
- Northwest along Miami River to NW 22 Avenue
- South to East-West Expressway (SR836)
- Northwest to 27 Avenue
- North to Miami River
- Northwest along Miami River to Seaboard Railroad
- North to NW 49 Street
- East to NW 27 Avenue
- North to NW 79 Street, point of beginning.

Current Boundary

Kinloch Park Middle School

Begin at SW 8 Street (SR41) and SW 67 Avenue

- North to East-West Expressway (SR836)
- East to Tamiami Canal
- Northeast on Tamiami Canal to Seaboard Railroad
- North on Seaboard RR to Miami River
- Southeast on Miami River to NW 27 Avenue
- South on 27 Avenue to W Flagler Street
- East on W Flagler Street to NW 22 Avenue
- South on NW 22 Avenue to SW 3 Street
- West on SW 3 Street to NW 27 Avenue
- South on NW 27 Avenue to SW 8 Street (SR41)
- West on SW 8 Street (SR41), point of beginning.

Current Boundary

Henry H. Filer Middle School

Begin at West 49 Street and Palm Avenue

- South to East 48 Street
- East to East 1 Avenue
- South to East 46 Street
- East to East 2 Avenue
- South to East 44 Street
- East to East 3 Avenue
- South to East 42 Street
- East to East 4 Avenue
- South to East 39 Street
- East to East 5 Avenue
- South to East 38 Street
- East to East 6 Avenue
- South to East 36 Street
- East to East 7 Avenue
- South to East 33 Street
- East to Seaboard Railroad
- South to East 21 Street (Florida East Coast Railroad)
- West to West 4 Avenue (Red Road)
- South to West 18 Street
- West to Okeechobee Canal Northwest to Palmetto Expressway (SR 826)
- North to West 37 Street
- East to West 4 Avenue (Red Road)
- North to West 49 Street
- East to Palm Avenue, point of beginning.

Recommended Boundary

Proposed boundary for Brownsville Middle School

Begin at NW 27 Avenue and NW 79 Street (SR934)

- East to NW 7 Avenue
- South to NW 67 Street
- West to NW 10 Avenue
- South to NW 62 Street
- East to NW 7 Avenue (SR441)
- South to NW 54 Street (SR944)
- West to NW 15 Avenue
- South to NW 52 Street
- West to NW 19 Avenue
- South to NW 46 Street
- West to NW 21 Avenue
- South to Airport Expressway (SR112)
- West to NW 22 Avenue
- South to NW 20 Street
- East to NW 17 Avenue
- South to Miami River
- Northwest along Miami River to NW 22 Avenue
- South to East-West Expressway (SR836)
- Northwest to 27 Avenue
- North to Miami River
- Northwest along Miami River to East 8 Avenue
- North to the Railroad
- East along the Railroad to NW 27 Avenue
- North to NW 79 Street, point of beginning.

Recommended Boundary

Proposed boundary for Kinloch Park Middle School

Begin at SW 8 Street (SR41) and SW 67 Avenue

- North to East-West Expressway (SR836)
- West to SR826
- North to Okeechobee Road
- Southeast to Palm Avenue
- North to NW 62 Street,
- East to East 8 Avenue,
- South to Miami River,
- Southeast on Miami River to NW 27 Avenue
- South on 27 Avenue to W Flagler Street
- East on W Flagler Street to NW 22 Avenue
- South on NW 22 Avenue to SW 3 Street
- West on SW 3 Street to NW 27 Avenue
- South on NW 27 Avenue to SW 8 Street (SR41)
- West on SW 8 Street (SR41),
point of beginning.

Recommended Boundary

Proposed boundary for Henry H. Filer Middle School

Begin at West 49 Street and Palm Avenue

- South to East 48 Street
- East to East 1 Avenue
- South to East 46 Street
- East to East 2 Avenue
- South to East 44 Street
- East to East 3 Avenue
- South to East 42 Street
- East to East 4 Avenue
- South to East 39 Street
- East to East 5 Avenue
- South to East 38 Street
- East to East 6 Avenue
- South to East 36 Street
- East to East 7 Avenue
- South to East 33 Street
- East to Seaboard Railroad
- South to East 21 Street (Florida East Coast Railroad)
- West to E 8 Avenue
- South to NW 62 Street
- West to Palm Avenue
- South to Okeechobee Road
- Northwest to Palmetto Expressway (SR 826)
- North to West 37 Street
- East to West 4 Avenue (Red Road)
- North to West 49 Street
- East to Palm Avenue,
point of beginning.

Effects

Beginning with the 2026 - 2027 School Year:

- Combine Miami Springs Middle School and Miami Springs Senior High School as the first 6-12 Academy in the city of Miami Springs.
- All rising 6th – 8th grade students currently in the Miami Springs Middle boundary may attend Brownsville Middle, Kinloch Park Middle, or Henry H. Filer Middle as their middle school option.
- Research highlights the benefits of a smoother transition to high school, building strong and positive relationships, and earlier access to college and career readiness pathways.
- Expanded academic and athletic opportunities for all students.

Effects

Beginning with the 2026 - 2027 School Year:

**Miami-Dade County Public Schools
Attendance Boundary Committee (ABC)
Capacity Membership Data**

Miami Springs Senior High School

Capacity Membership	Current 2025-2026	Projected 2026-2027	Projected 2027-2028
Grade Configuration	High (9-12)	Prep Academy (6-12)	Prep Academy (6-12)
Student Enrollment	1026	1591	1590
Perm FISH Cap	2011	2011	2011
% Utilization Perm FISH Cap	51.01%	79.11%	79.06%
Perm & Temp FISH Cap	2011	2011	2011
% Utilization Perm & Temp	51.01%	79.11%	79.06%



Proposed Attendance Boundary Recommendations South Region Office



Air Base K-8 Center Irving & Beatrice Peskoe K-8 Center
Leisure City K-8 Center Mandarin Lakes K-8 Center

Mr. Rafael A. Villalobos
Region Superintendent

Ms. Robin Y. Atkins
ABC Region Director

Impact

Due to declining enrollment and the ability to conduct a viable educational program, the following recommendations are proposed:

- Dissolve the current boundary for Mandarin Lakes K-8 Academy.
- Establish new boundaries for Leisure City K-8 and Irving & Beatrice Peskoe K-8 to include Mandarin Lakes boundary.
- Increased enrollment access to Air Base K-8 Center.
- Additional student seats to accommodate the community demand for the academic programs offered at Air Base K-8.
- Efficient use of existing physical infrastructure at Mandarin Lakes K-8

Current Boundaries

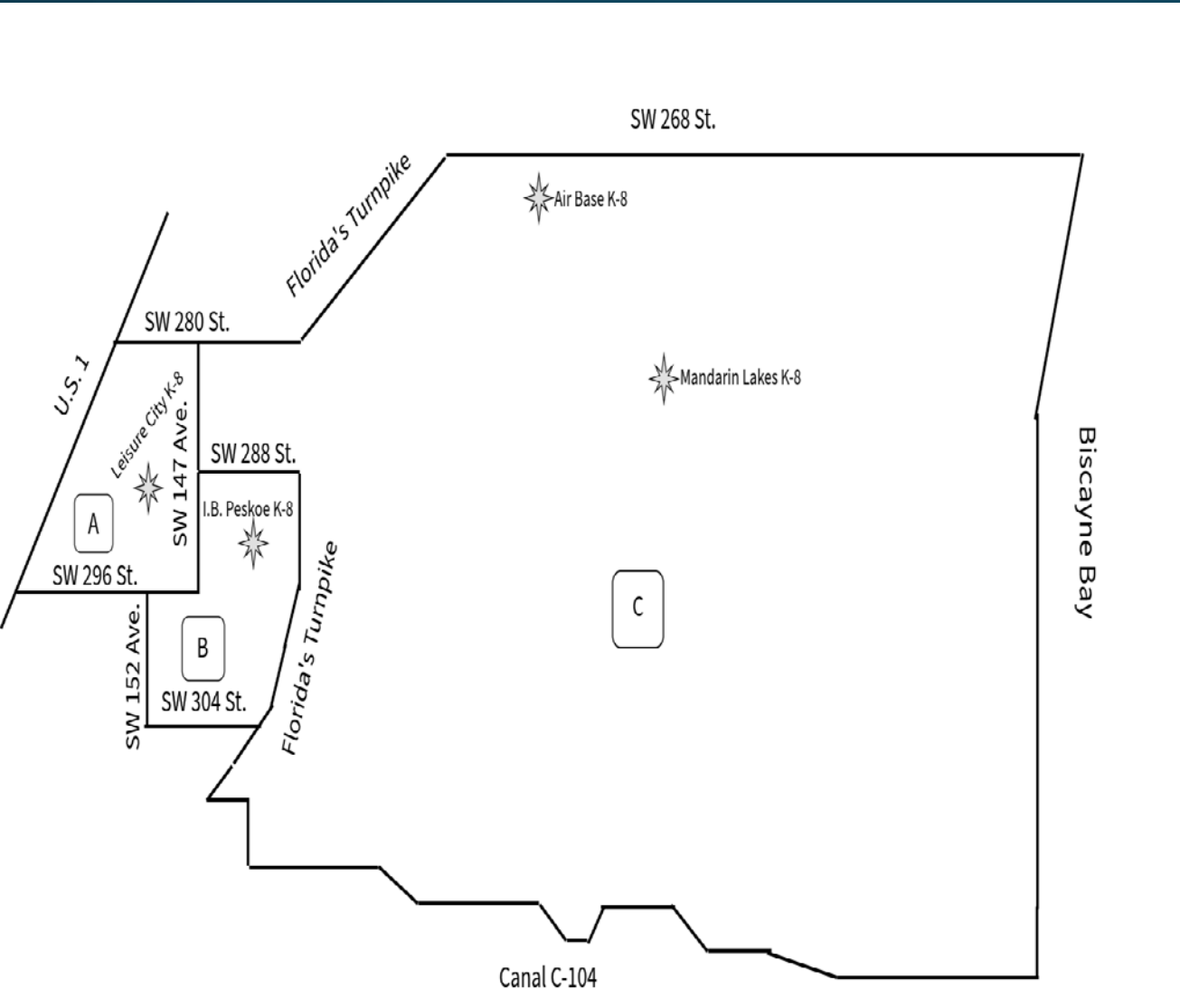

AREA	DESCRIPTION
A	Current boundary for Leisure City K-8
B	Current boundary for I.B. Peskoe K-8
C	Current boundary for Mandarin Lakes K-8

Mandarin Lakes K8 Center Boundary Analysis

School Name (Enrolled)	Count	%
Mandarin Lakes K-8 Center(0073)	478	16.53%
Charter School At Waterstone(1010)	333	11.52%
Keys Gate Charter School(3610)	202	6.99%
Air Base K-8 Ctr Int'L Educ (0041)	198	6.85%
Academir Charter Schl Math &S (4242)	176	6.09%
Leisure City K-8 Center (2901)	120	4.15%
Somerset Academy(Silver Palms) (0332)	107	3.7%
Everglades Preparatory Academy (5006)	105	3.63%
Irving & Beatrice Peskoe K-8 (4391)	94	3.25%
Somerset Prep Acad Homestead(0754)	69	2.39%
Academir Middle Math And Scien (2032)	60	2.08%
Somerset Prep Acad Middle(6046)	57	1.97%
Redland Middle (6761)	53	1.83%
William A. Chapman Elementary(0771)	42	1.45%
Somerset Acad Silver Palms @P(4012)	40	1.38%

A total of 2,891 students, in grades K thru 8 live within Mandarin K-8's boundary.

Mandarin Lakes K-8 Enrollment Trend Analysis

Grade Level Counts

UTILIZATION & CAPACITY	ENROLLMENT October Survey 2	Percent Utilization Capacity: 1508
19-20	858	56.9%
20-21	737	48.9%
21-22	750	49.7%
22-23	782	51.9%
23-24	746	49.5%

*Enrollment data: Assessment, Research, and Data Analysis (ARDA)
PK included if applicable. Capacity data: FISH reports*

GRADE LEVEL	2024-2025* (8/26/24)	2025-2026** (3/30/26)
K	53	59
1	49	58
2	52	53
3	79	72
4	68	54
5	76	61
6	76	66
7	70	63
8	82	57
TOTAL	605	543
Exiting Cohort	82	-23
Incoming Cohort	59	

*2024-25 grade level enrollment data from FASCO

** 2025-26 grade level enrollment data from Product W2390E01

Air Base K-8 Enrollment Trend Analysis

UTILIZATION & CAPACITY	ENROLLMENT October Survey 2	Percent Utilization Capacity: 1171
19-20	1122	95.8%
20-21	1111	94.9%
21-22	1084	92.6%
22-23	1109	94.7%
23-24	1102	94.1%

*Enrollment data: Assessment, Research, and Data Analysis (ARDA)
PK included if applicable. Capacity data: FISH reports*

Grade Level Counts

GRADE LEVEL	2024-2025* (8/26/24)	2025-2026** (3/30/26)
K	117	114
1	124	125
2	119	118
3	112	118
4	127	129
5	116	125
6	130	114
7	107	116
8	113	105
TOTAL	1065	1064
Exiting Cohort	113	
Incoming Cohort	114	1

*2024-25 grade level enrollment data from FASCO

** 2025-26 grade level enrollment data from Product W2390E01

Irving & Beatrice Peskoe K-8 Enrollment Trend Analysis

Grade Level Counts

UTILIZATION & CAPACITY	ENROLLMENT October Survey 2	Percent Utilization Capacity: 850
19-20	918	108.0%
20-21	812	95.5%
21-22	737	86.7%
22-23	763	89.8%
23-24	738	86.8%

Enrollment data: Assessment, Research, and Data Analysis (ARDA)
 PK included if applicable. Capacity data: FISH reports

GRADE LEVEL	2024-2025* (8/26/24)	2025-2026** (3/30/26)
K	52	59
1	62	56
2	76	66
3	99	85
4	79	83
5	97	87
6	82	86
7	70	78
8	83	63
TOTAL	700	663
Exiting Cohort	83	
Incoming Cohort	59	-24

*2024-25 grade level enrollment data from FASCO

** 2025-26 grade level enrollment data from Product W2390E01

Leisure City K-8 Enrollment Trend Analysis

Grade Level Counts

UTILIZATION & CAPACITY	ENROLLMENT October Survey 2	Percent Utilization Capacity: 1138	Grade Level Counts		
			GRADE LEVEL	2024-2025* (8/26/24)	2025-2026** (3/30/26)
19-20	1090	95.8%	K	104	103
20-21	1057	92.9%	1	101	119
21-22	1006	88.4%	2	104	94
22-23	1015	89.2%	3	120	117
23-24	1003	88.1%	4	94	111
			5	113	98
			6	106	106
			7	94	97
			8	108	88
			TOTAL	944	933
			Exiting Cohort	108	-5
			Incoming Cohort	103	

Enrollment data: Assessment, Research, and Data Analysis (ARDA)
 PK included if applicable. Capacity data: FISH reports

*2024-25 grade level enrollment data from FASCO
 ** 2025-26 grade level enrollment data from Product W2390E01

Current Boundaries

Air Base K-8 Center

- As a completely magnet school, it does not have attendance boundaries.

Assigned current boundary for Leisure City K-8 Center

Begin at SW 280 Street & U.S. 1

- East to SW 147 Avenue
- South to SW 296 Street
- West to U.S. 1
- North to SW 280 Street,
point of beginning

Current Boundaries

Assigned current boundaries for Mandarin Lakes K-8 Center

Begin at Florida's Turnpike and SW 268 Street

- East to Biscayne Bay
- South along coast to Canal C-103
- West along Canal C-103 to SW 152 Avenue
- North to Campbell Drive
- West to Florida's Turnpike
- North to SW 288 Street
- West to SW 147 Avenue
- North to SW 280 Street
- East to Florida's Turnpike, point of beginning

Current Boundaries

Assigned current boundaries for Irving & Beatrice Peskoe
K-8 Center

Begin at SW 147 Avenue & SW 288 Street

- East to Florida's Turnpike
- South to SW 304 Street
- West to SW 152 Avenue
- North to SW 296 Street
- East to SW 147 Avenue
- North to SW 288 Street,
point of beginning.

Recommended Boundary

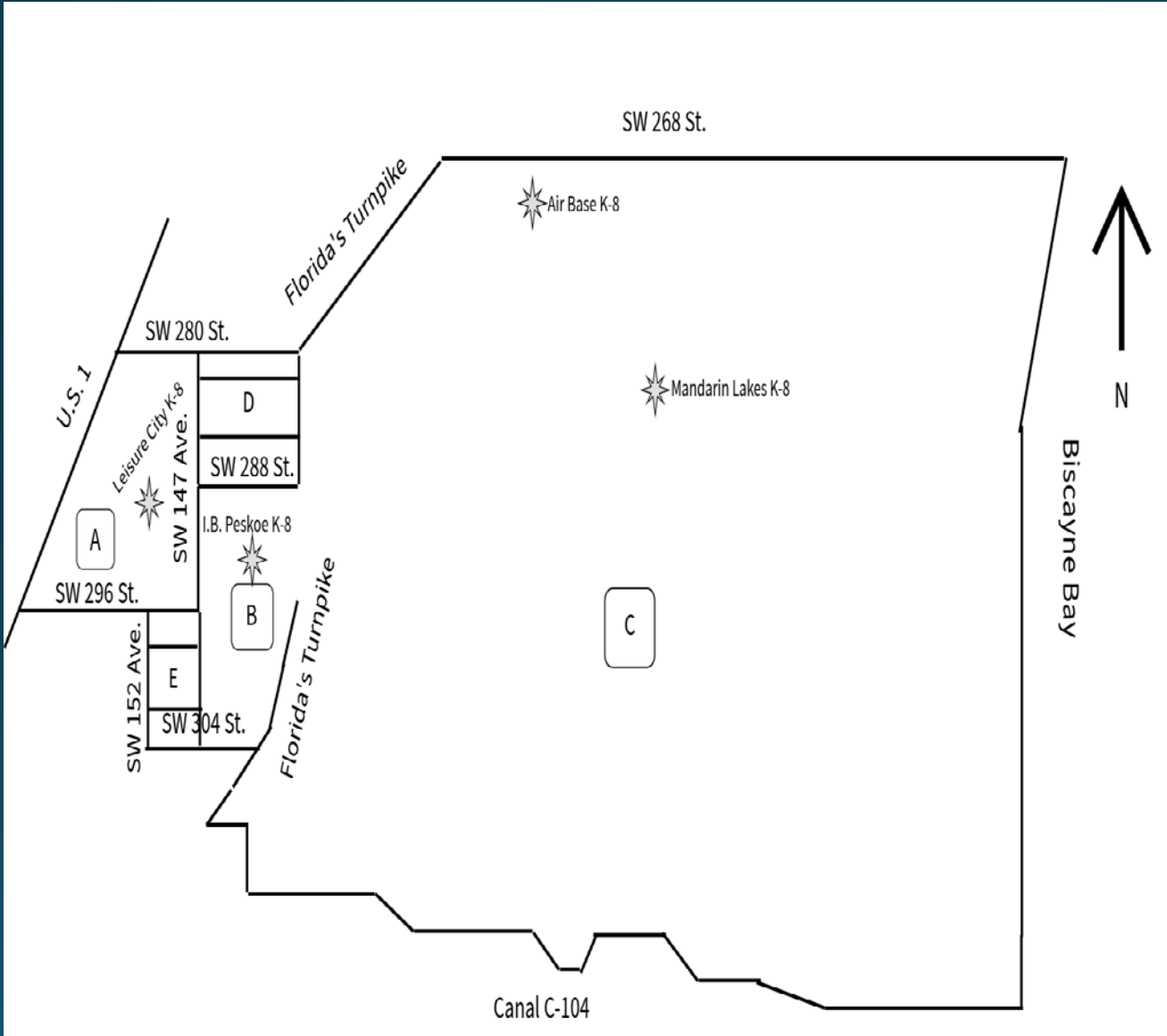

AREA	DESCRIPTION
A	Proposed new boundary for Leisure City K-8 incorporating Area D reassigned from Mandarin Lakes to Leisure City K-8 and reassigning Area E from I.B. Peskoe K-8 to Leisure City K-8
D	
E	
B	
C	
B	Proposed: New boundary for I.B. Peskoe K-8 combines its remaining boundary with the area currently assigned to Mandarin Lakes K-8

Recommended Boundaries

Proposed boundary for Areas A, D, & E

Schools Impacted: Leisure City K-8, I & B Peskoe K-8, & Mandarin Lakes K-8

Begin at U.S. 1 and SW 280 Street

- East to Florida's Turnpike
- South to SW 288 Street
- West to 147 Avenue
- South to SW 304 Street
- West to SW 152 Avenue
- North to SW 296 Street
- West to U.S. 1
- North to SW 280 Street,
point of beginning.

Recommended Boundaries

Proposed Boundary for Areas B & C

Schools Impacted: I & B Peskoe K-8 and Mandarin Lakes K-8

Begin SW 304 Street and SW 147 Avenue

- North, along the Florida's Turnpike to SW 288 Street
- East to the Florida's Turnpike
- South, along the Florida's Turnpike to Campbell Drive
- East to SW 152 Avenue
- East along Canal C-103 to Biscayne Bay
- North to SW 268 Street
- West to Florida's Turnpike
- South to SW 288 Street
- West to SW 147 Avenue
- South to SW 304 Street,

point of beginning.

Effects

- Establish new boundaries for Leisure City K-8 and Irving & Beatrice Peskoe K-8 to include Mandarin Lakes boundary.
- Beginning in the 2026-2027 school year, all Mandarin Lakes K8 students will transition to either Leisure City K-8 or I & B Peskoe K-8 according to the proposed boundary changes.
- Beginning with the 2026-2027 school year, all Air Base K8 students will relocate to the current Mandarin Lakes K-8 facility.
- Efficient use of existing physical infrastructure at Mandarin Lakes K-8

Effects

ACADEMIC AND EXTRA CURRICULAR OFFERINGS

School Name	Choice Program	Sports	After School Care	Clubs	Community
Leisure City K-8	Gifted (full time) Mariachi Cambridge* * <u>infused</u> in middle school Global Perspective elective; elementary infused school wide into project-based learning	Boys & Girls Flag Football Boys Soccer Boy & Girls Basketball Volleyball Track	Recapturing <u>the Vision</u> Young Musicians Unit Guitars over Guns	Robotics Bible Club Pearls 5000 Role Models Chess Club Student Dolphin Ambassadors Intermural Sports Knowledge Builders	Recapturing <u>the Vision</u> Mexican American Council Music Alliance Guitars over Guns Young Musicians Unite Caring for Miami South State Bank Texas <u>Road House</u> Raising Canes Outback Steakhouse Southern Pearls Top ladies of Distinction Top Taste Restaurant
Irving & Beatrice <u>Peskoe</u> K-8	Cambridge* * <u>infused</u> in middle school Global Perspective elective; elementary infused school wide into project-based learning	Cheerleading Dance Basketball Soccer Flag Football	YMCA	STEM Robotics <u>Peskoe</u> Chess Dance Cheerleading	All Pro Dads Initiative Phillip & Patricia Frost Museum of Science University of Florida- Scientist in Every Classroom The CLEO Institute The Everglades Foundation Christ Journey Church MAU Foundation

Effects

Air Base K-8 Center			
Capacity Membership	Current 2025-2026	Projected 2026-2027	Projected 2027-2028
Grade Configuration	K-8	K-8	K-8
Student Enrollment	1,135	1,473*	1,471*
Perm FISH Cap	1,171	1,508	1,508
% Utilization Perm FISH Cap	96.92%	97.6%	97.5%
Perm & Temp FISH Cap	1,268	1,508	1,508
% Utilization Perm & Temp	89.51%	97.6%	97.5%

*300 additional student stations will be created by the move of Air Base K-8 Center to the building currently housing Mandarin Lakes K-8.

Effects

Leisure City K-8			
Capacity Membership	Current 2025-2026	Projected 2026-2027	Projected 2027-2028
Grade Configuration	K-8	K-8	K-8
Student Enrollment	1,037	1036	1044
Perm FISH Cap	1,138	1,138	1,138
% Utilization Perm FISH Cap	91.12%	91.03%	91.73%
Perm & Temp FISH Cap	1,138	1,138	1,138
% Utilization Perm & Temp	91.12%	91.03%	91.73%

Effects

Irving & Beatrice Peskoe K-8 Center			
Capacity Membership	Current 2025-2026	Projected 2026-2027	Projected 2027-2028
Grade Configuration	K-8	K-8	K-8
Student Enrollment	681	1046	1009
Perm FISH Cap	850	850	850
% Utilization Perm FISH Cap	80.11%	123%	118%
Perm & Temp FISH Cap	866	866	866
% Utilization Perm & Temp	78.63%	120%	117%



Proposed Attendance Boundary Recommendations South Region Office



Robert Russa Moton Elementary Pine Lake Elementary

Mr. Rafael A. Villalobos
Region Superintendent

Ms. Robin Y. Atkins
ABC Region Director

Impact

Due to declining enrollment and the ability to conduct a viable educational program, the following recommendations are proposed:

- Dissolve the current boundary for Robert Russa Elementary School.
- Establish new boundaries for Robert Russa Elementary School.
- Combine the boundaries of Robert Russa Elementary School and Pine Lake Elementary School.

Current Boundaries

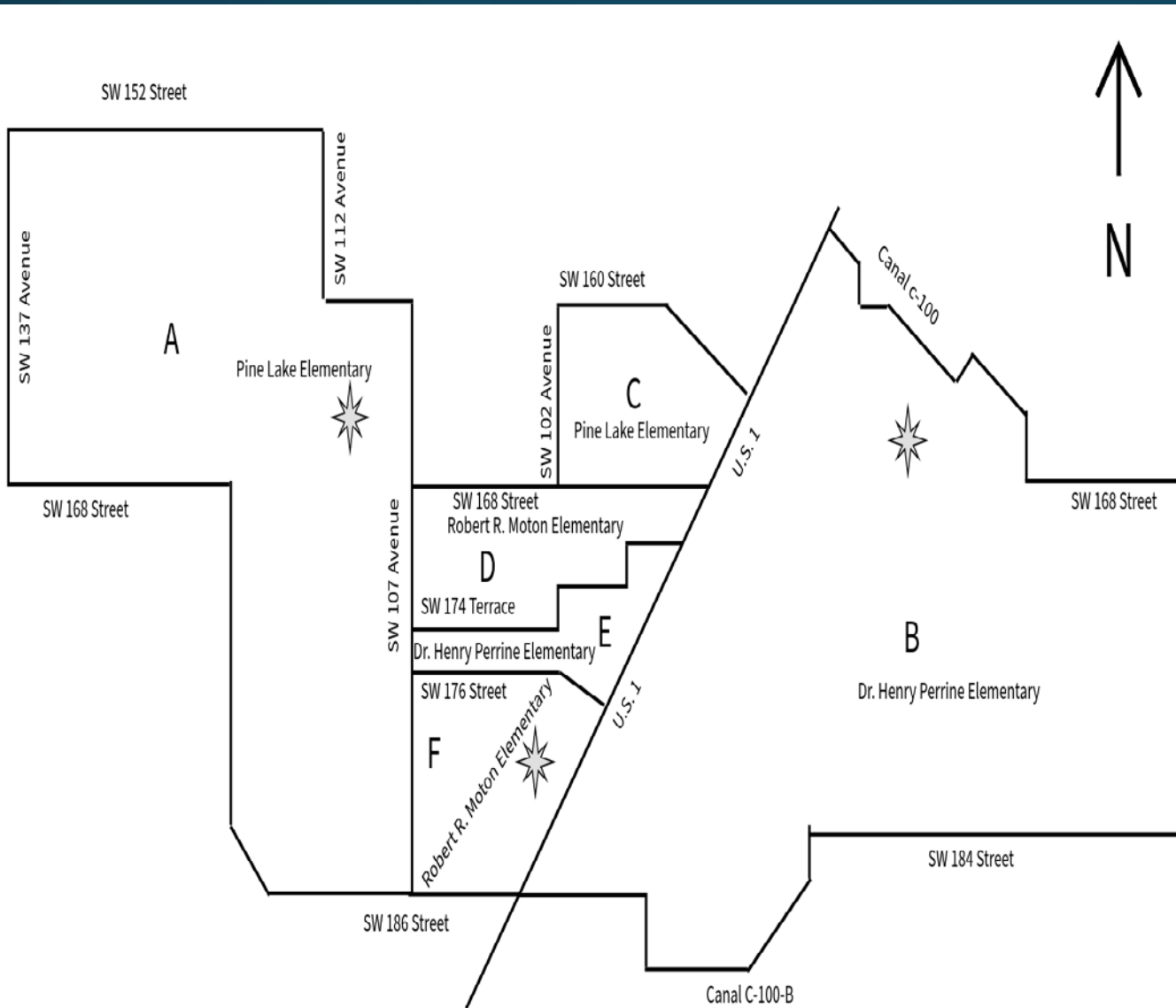

AREA	Description
A	Assigned boundary for Pine Lake E.S.
B	Assigned boundary for Dr. Henry Perrine E.S.
C	Assigned boundary for Pine Lake E.S.
D	Assigned boundary for Robert R. Moton E.S.
E	Assigned boundary for Dr. Henry Perrine E.S.
F	Assigned boundary for Robert R. Moton E.S.

Current Boundaries

School Name (Enrolled)	Count	%
Robert Russa Moton Elementary (3541)	103	32.59%
Dr Henry E Perrine Academy (4381)	31	9.81%
Pine Lake Elementary (4441)	28	8.86%
Johnnie MParris Colonial Dr.(0861)	16	5.06%
Frank C. Martin K-8 Center (3101)	13	4.11%
Gulfstream Elementary (2321)	13	4.11%
Gloria Floyd Elementary (2021)	9	2.85%
Academir Charter School Prep(1015)	8	2.53%
Bel-Aire Elementary (0261)	8	2.53%
Whispering Pines Elementary (5951)	7	2.22%

Currently, there are 316 students in grades K-5 that live within Robert Russa Moton Elementary's boundary. These are their top destinations.

Robert Russa Moton E.S. Enrollment Trend Analysis

Grade Level Counts

UTILIZATION & CAPACITY	ENROLLMENT October Survey 2	Percent Utilization Capacity: 679
19-20	290	42.7%
20-21	265	39.0%
21-22	203	29.9%
22-23	177	26.1%
23-24	161	23.7%

Enrollment data: Assessment, Research, and Data Analysis (ARDA)
PK included if applicable. Capacity data: FISH reports

GRADE LEVEL	2024-2025* (8/26/24)	2025-2026** (3/30/26)
K	28	26
1	25	27
2	25	18
3	27	15
4	23	20
5	27	15
TOTAL	155	121
Exiting Cohort	27	
Incoming Cohort	26	-1

*2024-25 grade level enrollment data from FASCO

** 2025-26 grade level enrollment data from Product W2390E01

Pine Lake E.S. Enrollment Trend Analysis

Grade Level Counts

UTILIZATION & CAPACITY	ENROLLMENT October Survey 2	Percent Utilization Capacity: 648
19-20	372	57.4%
20-21	371	57.3%
21-22	349	53.9%
22-23	377	58.2%
23-24	356	54.9%

Enrollment data: Assessment, Research, and Data Analysis (ARDA)
PK included if applicable. Capacity data: FISH reports

GRADE LEVEL	2024-2025* (8/26/24)	2025-2026** (3/30/26)
K	39	33
1	31	28
2	45	21
3	49	41
4	41	44
5	59	48
TOTAL	264	215
Exiting Cohort	59	
Incoming Cohort	33	-26

*2024-25 grade level enrollment data from FASCO

** 2025-26 grade level enrollment data from Product W2390E01

Current Boundaries

Assigned current boundary for Pine Lake Elementary

Begin at SW 152 Street & SW 137 Avenue

- East to SW 112 Avenue
- South to SW 160 Street
- East to SW 107 Avenue
- South to SW 186 Street
- West to Florida's Turnpike
- North to SW 168 Street
- West to SW 137 Avenue
- North to SW 152 Street

Eastern Satellite Boundary

- Begin at SW 168 Street and SW 102 Avenue
- North to SW 160 Street
- East to U.S. 1
- South to SW 168 Street
- West to SW 102 Avenue
- North to SW 160 Street, point of beginning.

Current Boundaries

Assigned current boundary for Dr. Henry Perrine Elementary

Begin at U.S. 1 and Canal C-100

- Southeast to SW 168 Street
- East to Biscayne Bay
- South to SW 184 Street
- West to Canal C-100-B
- West to SW 97 Avenue
- North to SW 186 Street
- West to U.S. 1
- North to Hibiscus Street
- West to SW 176 Street
- West to SW 107 Avenue
- North to SW 174 Terrace
- East to SW 102 Avenue
- North to SW 172 Street
- East to 99 Court
- North to SW 170 Street
- East to U.S. 1
- North to Canal C-100, point of beginning.

Current Boundaries

Assigned current boundary for Robert Russa Moton Elementary

Northern boundary begins at SW 168 St & SW 107 Avenue

- East to U.S. 1
- South to SW 170 Street
- West to SW 99 Court
- South to SW 172 Street
- West to SW 102 Avenue
- South to SW 174 Terrace
- West to SW 107 Avenue
- North to SW 168 Street
- End Northern boundary

Southern boundary begins at SW 176 Street & SW 107 Avenue

- East to Hibiscus Street
- East to U.S. 1
- South to SW 186 Street
- West to SW 107 Avenue
- North to SW 176 Street
- End Southern boundary

Recommended Boundary

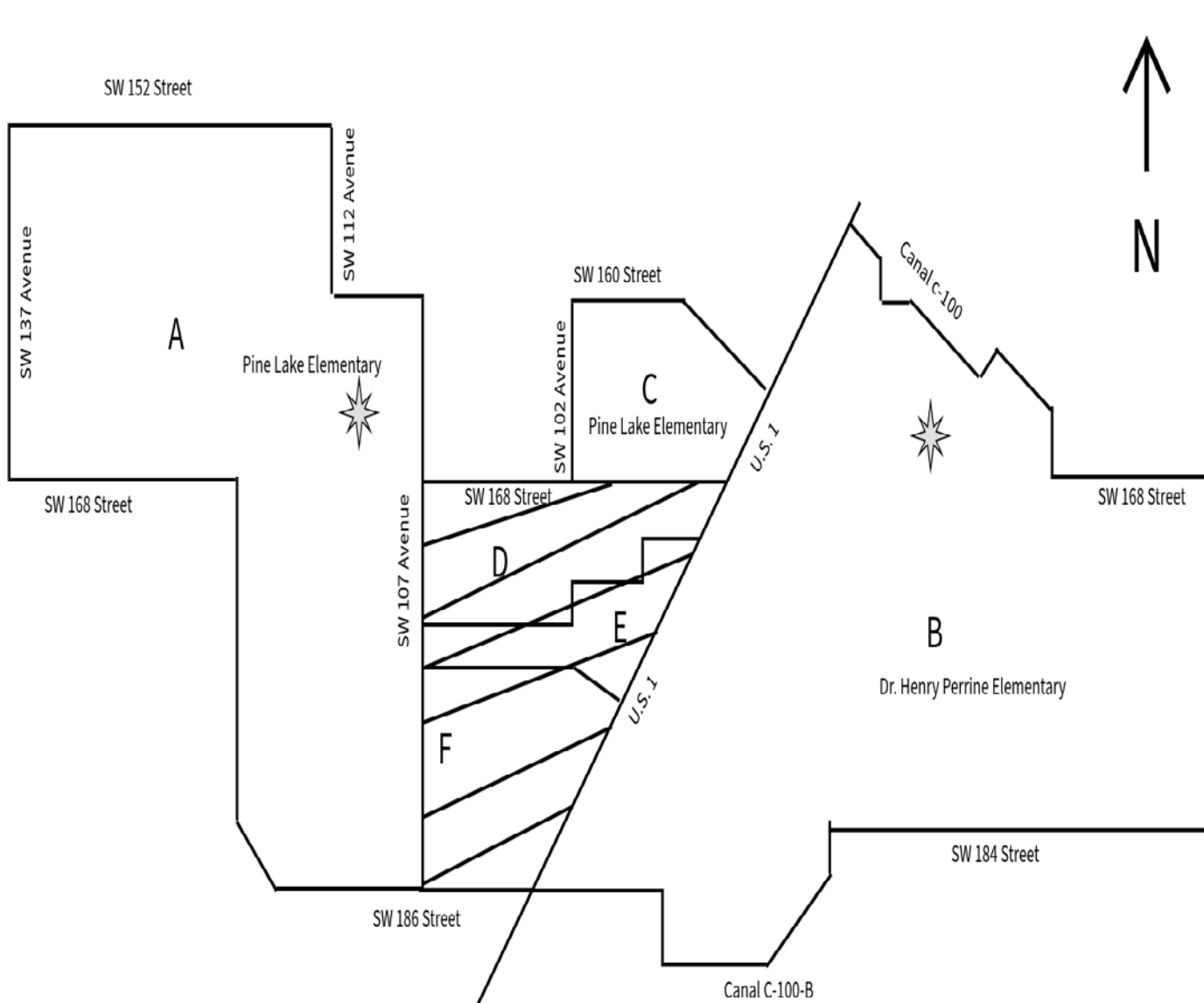

Area	Description
<p>A</p> <p>C</p> <p>D</p> <p>E</p> <p>F</p>	<p>Proposed boundary: R.R. Moton's boundaries (areas D & F) would be reassigned to Pine Lake Elementary. Furthermore, area E, currently assigned to Dr. Henry Perrine would be reassigned to Pine Lake Elementary. This would create one unified boundary.</p>
<p>B</p>	<p>Dr. Henry Perrine Elementary's boundary would remain completely east of U.S. 1. Area E would be reassigned to Pine Lake Elementary.</p>

Recommended Boundaries

Proposed boundary for Pine Lake Elementary

Begin at SW 152 Street & SW 137 Avenue.

- East to SW 112 Avenue
- South to SW 160 Street
- East to SW 107 Avenue
- South to SW 168 Street
- East to SW 102 Avenue
- North to SW 160 Street
- East to U.S. 1
- South to SW 186 Street
- West to Florida's Turnpike
- North to SW 168 Street
- West to SW 137 Avenue
- North to SW 152 Street, point of beginning.

Recommended Boundaries

Proposed boundary for Dr. Henry Perrine Elementary

Begin at U.S. 1 and Canal C-100

- Southeast to SW 168 Street
- East to Biscayne Bay
- South to SW 184 Street
- West to Canal C-100-B
- West to SW 97 Avenue
- North to SW 186 Street
- West to U.S. 1
- North to Canal C-100,
point of beginning.

Effects

Beginning with the 2026-2027 School Year:

- New boundaries will be established for Pine Lake Elementary School to include R.R. Moton Elementary School's boundary.
- Combine the boundaries of Pine Lake Elementary and R.R. Moton Elementary School.
- Establish new boundaries for Henry Perrine Elementary School.
- Dissolving R.R. Moton's boundaries, will increase student access to more robust academic programs and resources.
- An existing portion of Dr. Henry Perrine Elementary's boundary, west of U.S. 1, that splits R.R. Moton Elementary's current boundary, would be dissolved and future students would attend Pine Lake Elementary.
- Current Perrine students living within the proposed boundary changes can choose to remain at Dr. Henry Perrine.

Effects

ACADEMIC AND EXTRA CURRICULAR OFFERINGS

School Name	Choice/Magnet Program	After School Care	Clubs	Community
Pine Lake	Cambridge (Choice) and Zoo/Botany Magnet	YMCA Afterschool Care Girls Inc	Critter Club Robotics STEM Safety Patrol Wellness Cheerleading* *beginning with the 26-27 school year	Zoo Miami/Fairchild Tropical Gardens Partnership with Richmond Heights/BioTech

- Pine Lake Elementary School has a PLC which provides United Way, Head Start and VPK childcare available from 2 months to 4 years old.

Effects

Pine Lake Elementary			
Capacity Membership	Current 2025-2026	Projected 2026-2027	Projected 2027-2028
Grade Configuration	K-5	K-5	K-5
Student Enrollment	280	325	316
Perm FISH Cap	648	648	648
% Utilization Perm FISH Cap	43.20%	50%	48%
Perm & Temp FISH Cap	648	648	648
% Utilization Perm & Temp	43.20%	50%	48%

Effects

Dr. Henry E. Perrine Academy of the Arts			
Capacity Membership	Current 2025-2026	Projected 2026-2027	Projected 2027-2028
Grade Configuration	K-5	K-5	K-5
Student Enrollment	472	416	380
Perm FISH Cap	840	840	840
% Utilization Perm FISH Cap	56.19%	49%	45%
Perm & Temp FISH Cap	840	840	840
% Utilization Perm & Temp	56.19%	49%	45%

Proposed Attendance Boundary Recommendations South Region Office



Arthur & Polly Mays Conservatory of the Arts 6-12 & Pine Villa Elementary

Mr. Rafael A. Villalobos
Region Superintendent

Ms. Robin Y. Atkins
ABC Region Director

Impact

Due to declining student enrollment at Pine Villa Elementary School, Arthur & Polly Mays Conservatory of the Arts and Pine Villa Elementary School will merge to create a K-12 experience for students.

Current Boundaries

- Arthur & Polly Mays 6-12 does not have a boundary.
- Current boundary for Pine Villa Elementary:

Begin at U.S. 1 & Black Creek Canal

- East to SW 112 Avenue
- South to SW 232 Street
- West to U.S. 1
- North to Black Creek Canal
point of beginning.

Current Boundaries

Current boundary for Pine Villa Elementary:

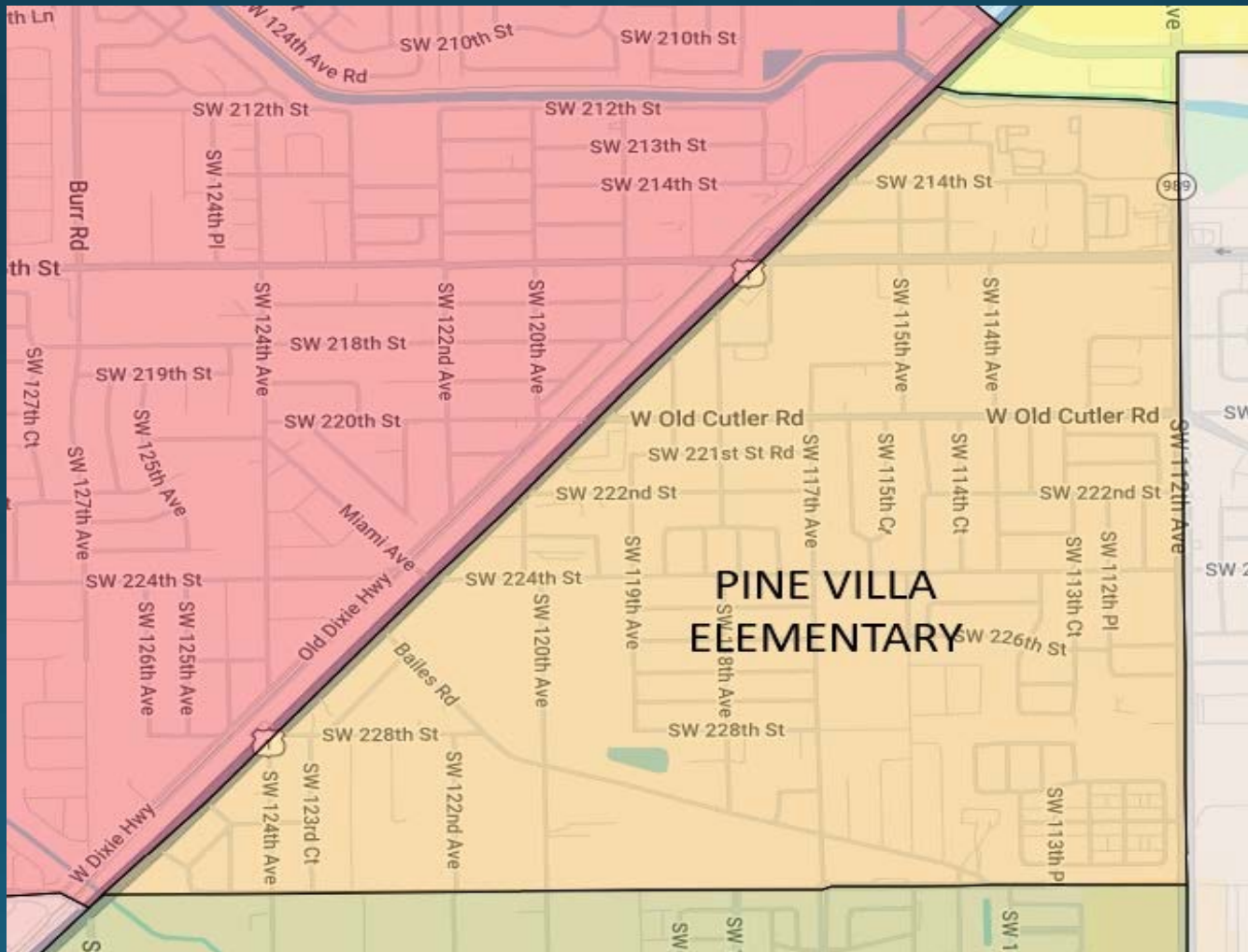

Pine Villa Elementary School Boundary Analysis

School Name (Enrolled)	Count	%
Pine Villa Elementary(4461)	93	23.85%
Somerset Academy(Silver Palms)(0332)	61	15.64%
Coral Reef Montessori Acad Ch (0070)	24	6.15%
Goulds Elementary(0311)	23	5.9%
Somerset Academy Silver Palms @ P (4012)	19	4.87%
Academir Charter School Prep (1015)	17	4.36%
Gulfstream Elementary(2321)	15	3.85%
Summerville Advantage Academy(0072)	12	3.08%
Caribbean K-8 Center(0661)	10	2.56%
South Point Scholars Academy(5836)	10	2.56%
Mater Academy Bay Elementary(4010)	9	2.31%

Currently, 390 students in grades K-5 live within Pine Villa Elementary's boundaries. These are their top destinations.

Pine Villa E.S. Enrollment Trend Analysis

Grade Level Counts

UTILIZATION & CAPACITY	ENROLLMENT October Survey 2	Percent Utilization Capacity: 834
19-20	378	45.3%
20-21	323	38.7%
21-22	280	33.6%
22-23	250	30.0%
23-24	253	30.3%

Enrollment data: Assessment, Research, and Data Analysis (ARDA)
PK included if applicable. Capacity data: FISH reports

GRADE LEVEL	2024-2025* (8/26/24)	2025-2026** (3/30/26)
K	17	14
1	20	16
2	21	30
3	28	16
4	26	31
5	22	27
TOTAL	134	134
Exiting Cohort	22	
Incoming Cohort	14	-8

*2024-25 grade level enrollment data from FASCO

** 2025-26 grade level enrollment data from Product W2390E01

Arthur & Poly Mays 6-12 Enrollment Trend Analysis

Grade Level Counts

UTILIZATION & CAPACITY	ENROLLMENT October Survey 2	Percent Utilization Capacity: 985
19-20	614	62.3%
20-21	612	62.1%
21-22	526	53.4%
22-23	513	52.1%
23-24	516	52.4%

Enrollment data: Assessment, Research, and Data Analysis (ARDA)
 PK included if applicable. Capacity data: FISH reports

GRADE LEVEL	2024-2025* (8/26/24)	2025-2026** (3/30/26)
6	108	66
7	99	93
8	76	79
9	54	44
10	62	42
11	59	49
12	58	51
TOTAL	516	424
Exiting Cohort	58	
Incoming Cohort	66	8

*2024-25 grade level enrollment data from FASCO

** 2025-26 grade level enrollment data from Product W2390E01

Recommended Boundaries

Students in grades K-5 living within the current Pine Villa Elementary School boundary can continue to attend Arthur and Polly Mays Conservatory of the Arts K-12 Lower Academy

Effects

Beginning with the 2026-2027 School Year:

- **Combine Arthur & Polly Mays Conservatory of the Arts and Pine Villa Elementary School to create Arthur & Polly Mays Conservatory of the Arts K-12 Upper and Lower Academy.**
- **Students will explore the various areas of the arts before declaring their interest at the secondary level.**

Effects

Arthur and Polly Mays Conservatory of the Arts			
Capacity Membership	Current 2025-2026	Projected 2026-2027	Projected 2027-2028
Grade Configuration	6-12	K-12	K-12
Student Enrollment	430	444	461
Perm FISH Cap	985	985	985
% Utilization Perm FISH Cap	43.65%	45%	46%
Perm & Temp FISH Cap	985	985	985
% Utilization Perm & Temp	43.65%	45%	46%

Effects

Pine Villa Elementary			
Capacity Membership	Current 2025-2026	Projected 2026-2027	Projected 2027-2028
Grade Configuration	K-5	K-12	K-12
Student Enrollment	240 (135 K-5)	121	103
Perm FISH Cap	834	834	834
% Utilization Perm FISH Cap	28.77% (16%)	15%	12%
Perm & Temp FISH Cap	834	834	834
% Utilization Perm & Temp	28.77%		

Proposed Attendance Boundary Recommendations South Region Office



Richmond Heights Middle & BioTech 9-12

Mr. Rafael A. Villalobos
Region Superintendent

Ms. Robin Y. Atkins
ABC Region Director

Impact

Due to declining student enrollment at Richmond Heights Middle School, BioTech and Richmond Heights Middle School will merge to create a 6-12 experience for students.

Richmond Heights Middle School Boundary Analysis

School Name (Enrolled)	Count	%
Richmond Heights Middle (6781)	203	16.05%
Herbert A. Ammons Middle (6001)	116	9.17%
Arvida Middle School (6021)	105	8.3%
Somerset Academy Middle (6004)	100	7.91%
Southwood Middle (6861)	74	5.85%
Jorge Mas Canosa Middle (6771)	69	5.45%
Bridgeprep Academy Village Gre (3036)	66	5.22%
Devon Aire K-8 Center (1331)	65	5.14%
Frank C. Martin K-8 Center (3101)	51	4.03%
Palmetto Middle (6701)	41	3.24%

Currently 1,265 students in grades 6-8 live within Richmond Heights Middle's boundaries. These are their top destinations.

Richmond Heights M.S. Enrollment Trend Analysis

Grade Level Counts

UTILIZATION & CAPACITY	ENROLLMENT October Survey 2	Percent Utilization Capacity: 914
19-20	512	56.0%
20-21	481	52.6%
21-22	495	54.2%
22-23	439	48.0%
23-24	412	45.1%

*Enrollment data: Assessment, Research, and Data Analysis (ARDA)
PK included if applicable. Capacity data: FISH reports*

GRADE LEVEL	2024-2025* (8/26/24)	2025-2026** (3/30/26)
6	109	77
7	107	106
8	129	86
TOTAL	345	269
Exiting Cohort		
Incoming Cohort	77	-52

*2024-25 grade level enrollment data from FASCO

** 2025-26 grade level enrollment data from Product W2390E01

Bio Tech SHS Enrollment Trend Analysis

Grade Level Counts

UTILIZATION & CAPACITY	ENROLLMENT October Survey 2	Percent Utilization Capacity: 219
19-20	388	177.2%
20-21	393	179.5%
21-22	360	164.4%
22-23	325	148.4%
23-24	324	147.9%

Enrollment data: Assessment, Research, and Data Analysis (ARDA)
PK included if applicable. Capacity data: FISH reports

GRADE LEVEL	2024-2025* (8/26/24)	2025-2026** (3/30/26)
9	72	56
10	88	79
11	72	85
12	64	68
TOTAL	296	288
Exiting Cohort	64	-8
Incoming Cohort	56	

*2024-25 grade level enrollment data from FASCO

** 2025-26 grade level enrollment data from Product W2390E01

Current Boundaries

Bio Tech 9-12 does not have attendance boundaries.

Current boundary for Richmond Heights Middle:

Begin at SW 137 Avenue & SW 120 Street

- East to Canal C-100
- Follow Canal C-100 south towards SW 117 Avenue
- South to SW 152 Street
- East to Harrison Street
- North to Graves Street
- Northeast to Polk Street
- North, then east, then north to the west of SW 110 Avenue to Canal C-100
- Follow Canal C-100 Southeast to U.S. 1
- South to SW 160 Street
- West to SW 99 Avenue

Current Boundaries (cont.)

Bio Tech 6-12 does not have attendance boundaries.

Current boundary for Richmond Heights Middle:

- South to between SW 164 Terrace and SW 165 Terrace
- East to SW 101 Avenue
- North to SW 163 Street
- West to SW 102 Avenue
- South to SW 164 Street
- West to SW 107 Avenue
- South to SW 184 Street
- West to SW 137 Avenue
- North to SW 120 Street, point of beginning.

Recommended Boundaries

Students in grades 6-8 living within the current Richmond Heights Middle School boundary can continue to attend BioTech @ Richmond Heights 6-12 School.

Effects

- Richmond Heights Middle and BioTech will merge to become BioTech @ Richmond Heights 6-12 School.
- Strengthen School Resources and enhance academic programs.
- Provide students access to hands on field experiences, as well as environmental partners.
- Middle school students will have the opportunity to experience the various areas of conservation biology.

Effects

EXTRA CURRICULAR OFFERINGS

School Name	Magnet Program	Clubs	Community
<u>BioTech</u>	Conservation Biology (Zoology/Botany)	Blue Club Conservation Drama Gardening Media Music SECME Sewing & Embroidery Youth Fellowship Scrub Jay Society	Zoo Miami Fairchild Tropical Botanic Garden Everglades National Park

Effects

Richmond Heights Middle			
Capacity Membership	Current 2025-2026	Projected 2026-2027	Projected 2027-2028
Grade Configuration	6-8	6-12	6-12
Student Enrollment	270	260	228
Perm FISH Cap	914	914	914
% Utilization Perm FISH Cap	29.54%	28%	25%
Perm & Temp FISH Cap	973	973	973
% Utilization Perm & Temp	27.74%	26%	23%

Effects

Biotech @ Richmond Heights 9-12 Senior High			
Capacity Membership	Current 2025-2026	Projected 2026-2027	Projected 2027-2028
Grade Configuration	9-12	6-12	6-12
Student Enrollment	290	278	249
Perm FISH Cap	219	219	219
% Utilization Perm FISH Cap	132.42%	126%	113%
Perm & Temp FISH Cap	345	345	345
% Utilization Perm & Temp	84.05%	80.5%	72%

Proposed Attendance Boundary Recommendations South Region Office



The South Region logo is located in the bottom left corner. It features a red square with a white graduation cap, a green square with a white mask and musical instrument, a blue square with a white torch, and a yellow square with a white atom symbol and the Greek letter pi. Below these icons is the text 'SOUTH REGION' and 'Excellence by Design'. A circular seal for Miami-Dade County is also present.

Miami Southridge Senior High School South Dade Senior High School

Mr. Rafael A. Villalobos
Region Superintendent

Ms. Robin Y. Atkins
ABC Region Director

Impact

Decrease overcrowding occurring at South Dade Senior High School.

Current Boundaries

Assigned current boundary for Miami Southridge Senior High

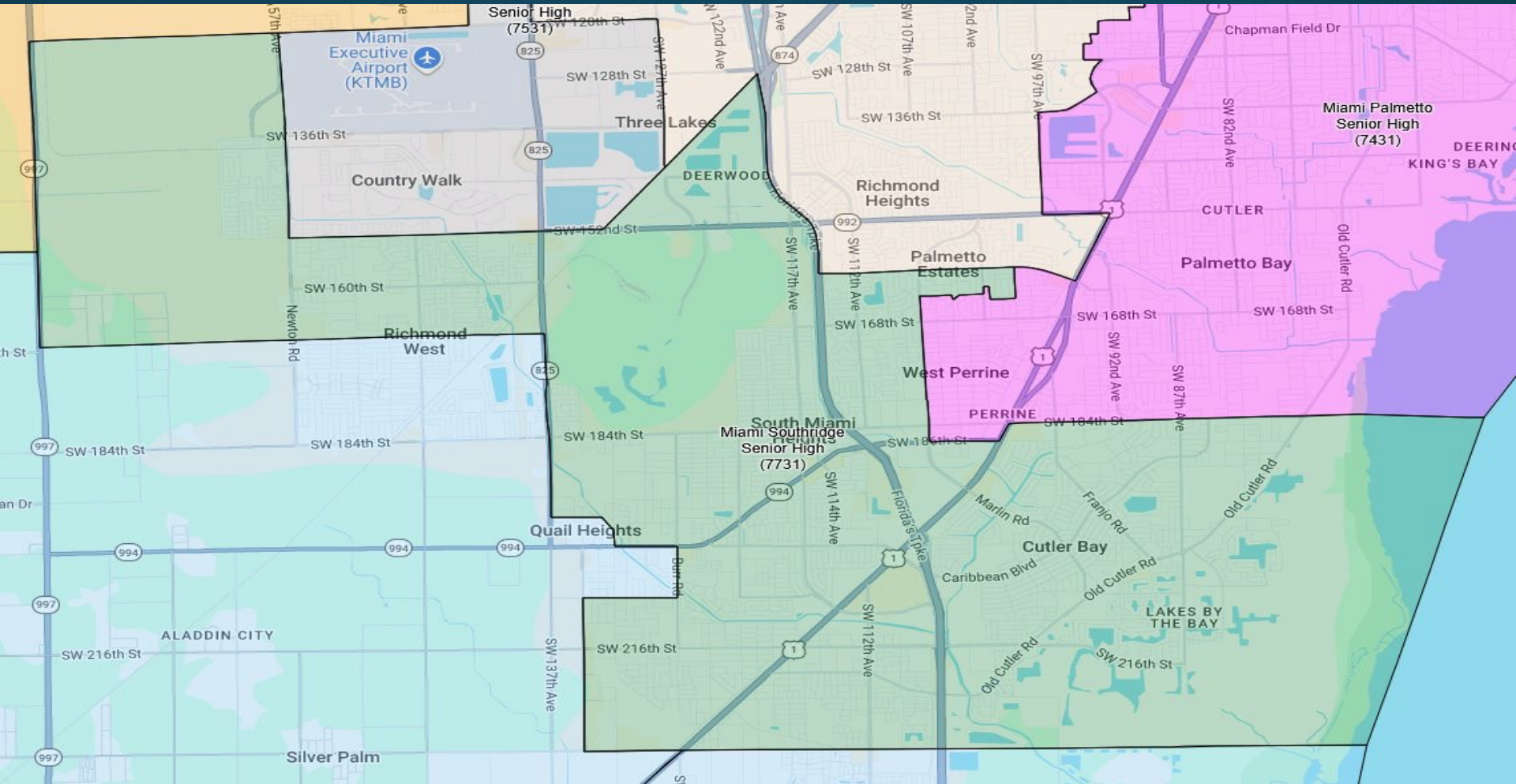

Miami Southridge Senior High Boundary Analysis

School Name (Enrolled)	Count	%
Miami Southridge Senior High (7731)	1639	25.74%
Coral Reef Senior High(7101)	985	15.47%
Robert Morgan Educational Ctr (7371)	560	8.8%
Miami Palmetto Senior High (7431)	447	7.02%
Cutler Bay Senior High(6081)	339	5.32%
Mater Academy Bay High School (7120)	253	3.97%
Somerset College Prep Acad So.(7078)	250	3.93%
John A Ferguson Senior High (7121)	242	3.8%
Somerset Academy Charter High (7042)	213	3.35%
Felix Varela Senior High(7781)	176	2.76%

Currently there are 6,367 students in grades 9-12 that live within Miami Southridge Senior's boundaries. These are their top destinations.

South Dade SHS Enrollment Trend Analysis

Grade Level Counts

UTILIZATION & CAPACITY	ENROLLMENT October Survey 2	Percent Utilization Capacity: 3302
19-20	3200	96.9%
20-21	3146	95.3%
21-22	3082	93.3%
22-23	3142	95.2%
23-24	3252	98.5%

*Enrollment data: Assessment, Research, and Data Analysis (ARDA)
PK included if applicable. Capacity data: FISH reports*

GRADE LEVEL	2024-2025* (8/26/24)	2025-2026** (3/30/26)
9	836	932
10	942	901
11	827	857
12	755	745
TOTAL	3,360	3435
Exiting Cohort	755	177
Incoming Cohort	932	

*2024-25 grade level enrollment data from FASCO

** 2025-26 grade level enrollment data from Product W2390E01

Southridge SHS Enrollment Trend Analysis

Grade Level Counts

UTILIZATION & CAPACITY	ENROLLMENT October Survey 2	Percent Utilization Capacity: 2452	GRADE LEVEL	2024-2025* (8/26/24)	2025-2026** (3/30/26)
19-20	1861	75.9%	9	505	511
20-21	1970	80.3%	10	635	503
21-22	1930	78.7%	11	601	510
22-23	2076	84.7%	12	493	544
23-24	2234	91.1%	TOTAL	2,234	2068
<i>Enrollment data: Assessment, Research, and Data Analysis (ARDA)</i> <i>PK included if applicable. Capacity data: FISH reports</i>			Exiting Cohort	493	18
			Incoming Cohort	511	

*2024-25 grade level enrollment data from FASCO

** 2025-26 grade level enrollment data from Product W2390E01

Current Boundaries

Begin at SW 177 Avenue & SW 120 Street

- East to SW 157 Avenue
- South to SW 152 Street
- East to CSX Railroad
- Northeast along CSX railroad to Florida's Turnpike
- South to SW 160 Street
- East to SW 99 Avenue
- South to SW 164 Terrace
- West to SW 101 Avenue
- North to SW 163 Street
- West to SW 102 Avenue
- South to SW 164 Street
- West to SW 104 Avenue
- North to SW 164 Street
- West to SW 107 Avenue
- South to SW 186 Street
- East to U.S. 1
- North to SW 184 Street
- East to Biscayne Bay
- South to SW 232 Street
- West to SW 134 Avenue
- North to SW 208 Street
- East to SW 127 Avenue
- North to SW 200 Street
- West to SW 132 Avenue
- North to Black Creek Canal
- Northwest to approx. SW 195 Street
- West to SW 137 Avenue
- North to SW 168 Street
- West to SW 177 Avenue
- North to SW 120 Street, point of beginning

Recommended Boundaries

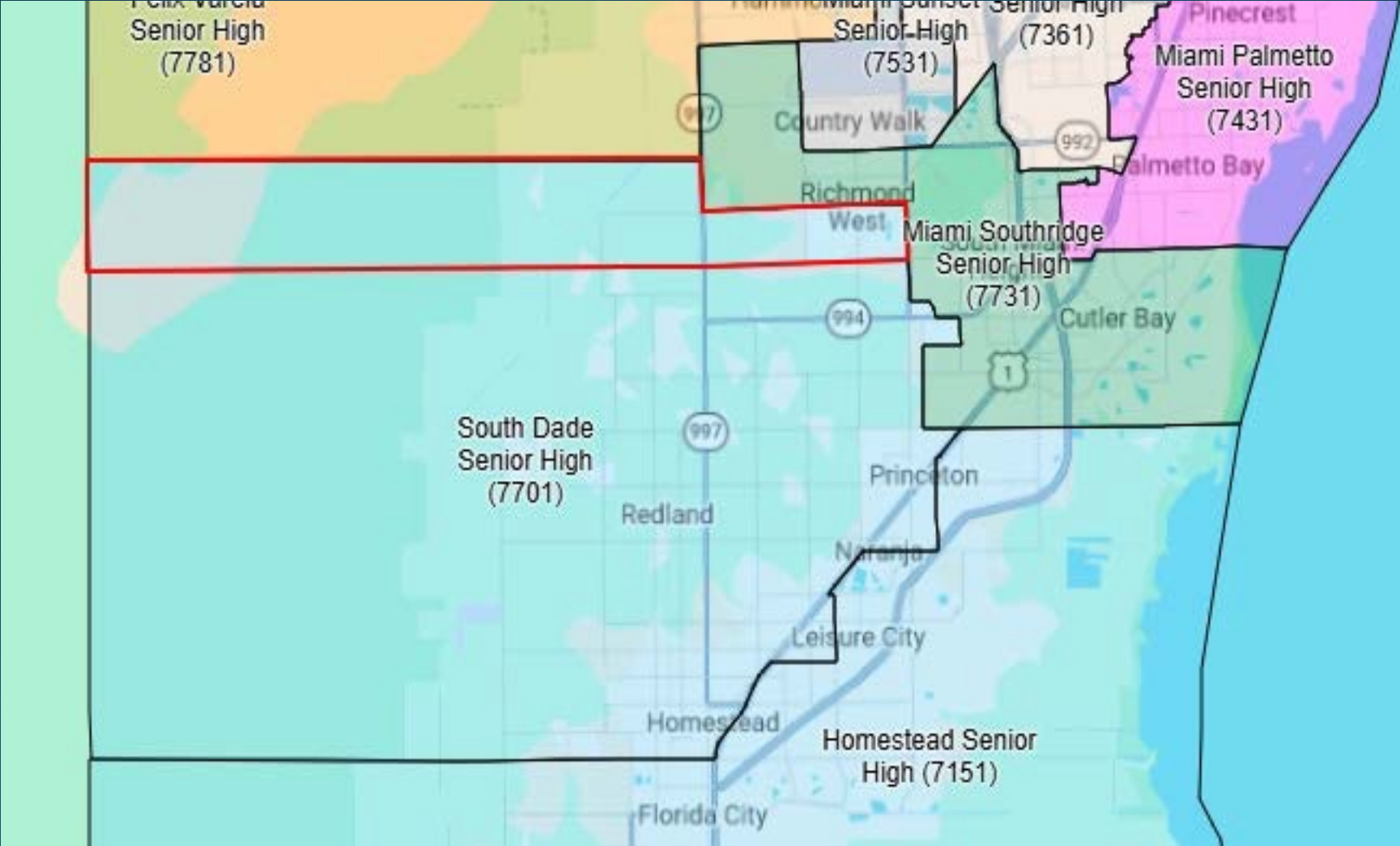

Recommended Boundary

- Begin at SW 177 Avenue & SW 120 Street
 - East to SW 157 Avenue
 - South to SW 152 Street
 - East to CSX Railroad
 - Northeast along CSX railroad to Florida's Turnpike
 - South to SW 160 Street
 - East to SW 99 Avenue
 - South to SW 164 Terrace
 - West to SW 101 Avenue
 - North to SW 163 Street
 - West to SW 102 Avenue
 - South to SW 164 Street
 - West to SW 104 Avenue
 - North to SW 164 Street
 - West to SW 107 Avenue
 - South to SW 186 Street
 - East to U.S. 1
 - North to SW 184 Street
 - East to Biscayne Bay
 - South to SW 232 Street
 - West to SW 134 Avenue
 - North to SW 208 Street
 - East to SW 127 Avenue
 - North to SW 200 Street
 - West to SW 132 Avenue
 - North to Black Creek Canal
 - Northwest to approx. SW 195 Street
 - West to SW 137 Avenue
 - North to SW 168 Street
 - West to the Florida Everglades
 - North to approximately SW 136 Street
 - East to SW 177 Avenue
 - North to SW 120 Street, point of beginning

Effects

Beginning with the 2026-2027 School Year:

- Decrease overcrowding occurring at South Dade Senior High School.

Effects

South Dade SHS			
Capacity Membership	Current 2025-2026	Projected 2026-2027	Projected 2027-2028
Grade Configuration	9-12	9-12	9-12
Student Enrollment	3,482	3,642	3,720
Perm FISH Cap	3,302	3,302	3,302
% Utilization Perm FISH Cap	105.45%	110%	112%
Perm & Temp FISH Cap	3,302	3,302	3,302
% Utilization Perm & Temp	105.45%	110%	112%

Effects

Southridge SHS			
Capacity Membership	Current 2025-2026	Projected 2026-2027	Projected 2027-2028
Grade Configuration	9-12	9-12	9-12
Student Enrollment	2101	2066	2075
Perm FISH Cap	2452	2452	2452
% Utilization Perm FISH Cap	85.68%	84%	84.62%
Perm & Temp FISH Cap	2452	2452	2452
% Utilization Perm & Temp	85.68%	84%	84.62%

**MIAMI-DADE COUNTY PUBLIC SCHOOLS
ATTENDANCE BOUNDARY COMMITTEE (ABC)
2025-2026 FINAL TARGETED AND FINAL ADVISED SCHOOLS**

FINAL TARGETED SCHOOLS		
NORTH REGION	CENTRAL REGION	SOUTH REGION
<p>Parkway Elementary</p> <ul style="list-style-type: none"> Norland Elementary <p>Rainbow Park Elementary</p> <ul style="list-style-type: none"> Bunche Park Elementary Dr. Robert Ingram Elementary <p>Central Region Boundary – Miami Springs Middle</p> <ul style="list-style-type: none"> Westland Hialeah High Henry H. Filer Middle 	<p>Georgia Jones-Ayers Middle</p> <ul style="list-style-type: none"> Lenora B. Smith Elementary Brownsville Middle Jose de Diego Middle <p>Phillis Wheatley Elementary</p> <ul style="list-style-type: none"> Frederick Douglass Elementary Paul L. Dunbar K-8 Center <p>Miami Springs Middle</p> <ul style="list-style-type: none"> Miami Springs Senior High Brownsville Middle Kinloch Park Middle Westland Hialeah High (NRO) Henry H. Filer Middle (NRO) 	<p>Biotech @ Richmond Heights 9-12 Senior High</p> <ul style="list-style-type: none"> Richmond Heights Middle <p>Mandarin Lakes K-8 Academy</p> <ul style="list-style-type: none"> Air Base K-8 Center for International Education Irving & Beatrice Peskoe K-8 Leisure City K-8 <p>Pine Villa</p> <ul style="list-style-type: none"> Arthur and Polly Mays Conservatory of the Arts <p>Robert Russa Moton Elementary</p> <ul style="list-style-type: none"> Dr. Henry E. Perrine Academy of the Arts Pine Lake Elementary <p>Southridge Senior High</p> <ul style="list-style-type: none"> South Dade Senior High
FINAL ADVISED SCHOOLS		
NORTH REGION	CENTRAL REGION	SOUTH REGION
<p>Golden Glades Elementary</p> <p>Myrtle Grove Elementary</p> <p>North Dade Middle</p> <ul style="list-style-type: none"> Carol City Middle Norland Middle 	<p>Lorah Park Elementary</p> <ul style="list-style-type: none"> ASP/Olinda Elementary Earlington Heights Elementary 	<p>Center for International Education (CIE)</p> <ul style="list-style-type: none"> Campbell Drive K-8 Center Homestead Senior High <p>Miami Killian Senior High</p>



Questions/ Comments

OFFICE OF SCHOOL LEADERSHIP & PERFORMANCE



ATTENDANCE BOUNDARY COMMITTEE